

## Ventilation Catalog V1



**Air Diffuser and Grille 02**



**Flexible Air Duct, Plastic Air Duct 22**



**Spiral Duct and Fitting, Damper, Access Door 28**



**Ductwork Components and Accessories 40**



**Adhesive Tape, Thermal Insulation Material, Sealant 50**



**Ventilation Air Filters 54**



**Ventilation Fans 56**



**Air Valves**



**Vent Caps and Louves**



**Air Diffusers**



**Air Grillers**

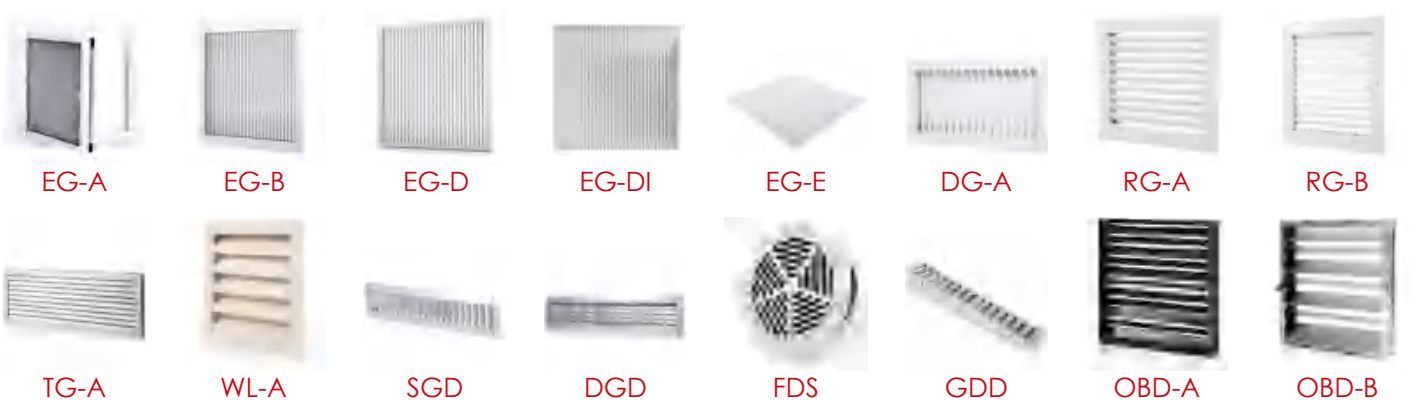

**Australian Series**



**American Series**



Air Diffuser and Grille

Air Diffuser and Grille

Flexible Air Duct, Plastic Air Duct

Spiral Duct and Fitting, Damper, Access Door

Ductwork Components and Accessories

Adhesive Tape, Thermal Insulation Material, Sealant

Ventilation Air Filters

Ventilation Fans



**Air Valves**



**EV**  
Metal Exhaust Air Valve

- Manufactured from sheet steel with white powder coated finish.
- The valve body is equipped with a sponge gasket to form an air-tight seal.
- Supplied with mounting collar.

|        | A(mm) | B(mm) | C(mm) | D(mm) |
|--------|-------|-------|-------|-------|
| EV 80  | 115   | 62    | 42    | 77.5  |
| EV 100 | 138   | 75    | 40    | 97.5  |
| EV 125 | 164   | 100   | 46    | 122.5 |
| EV 150 | 202   | 120   | 50    | 147.5 |
| EV 160 | 211   | 130   | 54    | 157.5 |
| EV 200 | 248   | 158   | 63    | 197.5 |



**SV**  
Metal Supply Air Valve

- Manufactured from sheet steel with white powder coated finish.
- The valve body is equipped with a sponge gasket to form an air-tight seal.
- Supplied with mounting collar.

|        | A(mm) | B(mm) | C(mm) | D(mm) |
|--------|-------|-------|-------|-------|
| SV 80  | 115   | 76    | 42    | 77.5  |
| SV 100 | 138   | 92    | 40    | 97.5  |
| SV 125 | 164   | 111   | 46    | 122.5 |
| SV 150 | 202   | 135   | 50    | 147.5 |
| SV 160 | 211   | 147   | 54    | 157.5 |
| SV 200 | 248   | 194   | 63    | 197.5 |



**VS**  
Stainless Air Valve

- All Stainless steel 304 construction, excellent feature of antirust.
- Supplied with mounting ring.

|        | A(mm) | B(mm) | C(mm) |
|--------|-------|-------|-------|
| VS 100 | 95    | 118   | 52    |
| VS 125 | 120   | 141   | 52    |
| VS 150 | 145   | 165   | 62    |
| VS 160 | 155   | 175   | 62    |
| VS 200 | 195   | 220   | 74    |



**VP**  
Plastic Air Valve

- Manufactured from white polypropylene heat resistant to 100 C .
- For mounting in places with small spaces, a retaining ring can be added.

|      | A(mm) | B(mm) | C(mm) | D(mm) |
|------|-------|-------|-------|-------|
| φ100 | 80    | 148   | 87    | 20    |
| φ125 | 100   | 168   | 106   | 20    |
| φ150 | 118   | 186   | 130   | 20    |
| φ200 | 171   | 240   | 178   | 20    |



**EVF**  
Metal Exhaust Air Valve

- Manufactured from sheet steel with a white powder coated finish.
- The valve body is equipped with a cellular sponge gasket.

|         | A(mm) | B(mm) | C(mm) |
|---------|-------|-------|-------|
| EVF 80  | 80    | 108   | 16    |
| EVF 100 | 100   | 137   | 16    |
| EVF 125 | 125   | 162   | 16    |
| EVF 160 | 150   | 193   | 16    |
| EVF 200 | 200   | 240   | 19    |



**SVF**  
Metal Supply Air Valve

- Manufactured from sheet steel with a white powder coated finish.
- The valve body is equipped with a cellular sponge gasket.

|         | H     | A(mm) | B(mm) |
|---------|-------|-------|-------|
| SVF 80  | 27-57 | 108   | 80    |
| SVF 100 | 27-57 | 137   | 100   |
| SVF 125 | 27-57 | 162   | 125   |
| SVF 160 | 27-57 | 193   | 160   |
| SVF 200 | 27-60 | 240   | 200   |



Collar A



Collar B



Collar C

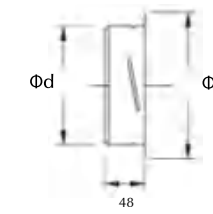

**Mounting Collar for Metal Valve**

- Designed for use with EV / SV series metal air valves.
- Made of galvanized steel sheet employing the draw press technique.

| Size | φD(mm) | φd(mm) |
|------|--------|--------|
| 80   | 105    | 79     |
| 100  | 125    | 99     |
| 125  | 150    | 124    |
| 150  | 175    | 149    |
| 160  | 185    | 159    |
| 200  | 225    | 199    |



VPA



VPC

**Plastic Air Grille**

- Matt white finish.
- Made from impact resistant ABS plastic.

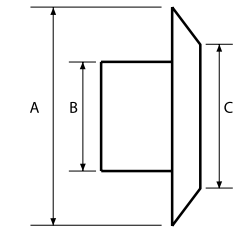

VPL



VPO

| VP    | φ75 | φ100 | φ125 | φ150 | φ200 |
|-------|-----|------|------|------|------|
| A(mm) | 115 | 148  | 168  | 210  | 260  |
| B(mm) | 75  | 100  | 125  | 150  | 200  |
| C(mm) | 75  | 75   | 80   | 80   | 90   |



VPPS

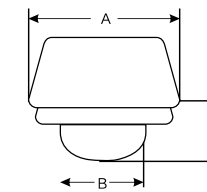

- Matt white finish.
- Made from impact resistant ABS plastic.

|         | A(mm) | B(mm) | C(mm) |
|---------|-------|-------|-------|
| VPPS100 | 138   | 97    | 77    |



VPPR

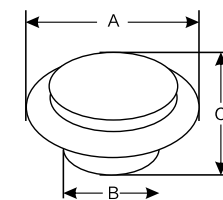

- Supplied with PP Material non-woven filter and activated carbon silencing cotton.
- Press semi-automatic air volume adjustment.

|       | A(mm) | B(mm) | C(mm) |
|-------|-------|-------|-------|
| 80mm  | 140   | 77    | 77    |
| 100mm | 160   | 97    | 77    |
| 120mm | 190   | 116   | 77    |
| 150mm | 240   | 146   | 78    |



VPRS



VPRR

- Matt white finish.
- Made from impact resistant ABS plastic.
- Supplied with PP Material non-woven filter and activated carbon silencing cotton.

Vent Caps and Louves



**VLA**  
Stainless Vent Hood

- Made of stainless steel 304, brushed surface finish.
- Supplied with insect screen, fixing clips, rubber sealing.

|     | A(mm) | B(mm) | C(mm) |
|-----|-------|-------|-------|
| 100 | 97    | 132   | 52    |
| 125 | 120   | 165   | 52    |
| 150 | 145   | 192   | 62    |
| 160 | 155   | 192   | 62    |
| 200 | 195   | 253   | 74    |

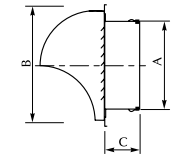

**VLB**  
Stainless Vent Hood

- Made of stainless steel 304, brushed surface finish.
- Supplied with insect mesh, fixing clips, rubber sealing.
- Packed in a transparent bag, including 2 stainless screw.

|     | A(mm) | B(mm) | C(mm) |
|-----|-------|-------|-------|
| 100 | 97    | 132   | 52    |
| 125 | 120   | 165   | 52    |
| 150 | 145   | 192   | 62    |
| 160 | 155   | 192   | 62    |
| 200 | 195   | 253   | 74    |

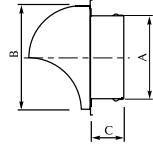

**SUA**  
Stainless External Louver

- Made of stainless steel sheet 304, polishing surface finish.
- The shutter allows one-way air passage, the cowl prevent rainwater from entering the ducts.

|     | A(mm) | B(mm) | C(mm) |
|-----|-------|-------|-------|
| 100 | 97    | 137   | 52    |
| 125 | 120   | 167   | 52    |
| 150 | 145   | 167   | 62    |

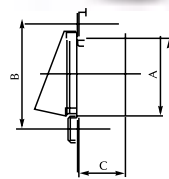

**SUA-PA**  
Plastic Vent Louver

**SUA-PB**  
Plastic Vent Louver

- All PVC plastic design.
- Neck size: 100mm, 125mm, 150mm, 160mm



**VLC**  
Stainless Vent Hood

- Made of stainless steel 304, polishing surface finish.
- With protection mesh, fixing clips, rubber sealing.
- Packed in a transparent bag, including 2 stainless screw.



**SMS-PG**



**SMS-PM**  
Plastic Vent Louver

- With built in molded screen.
- Anti-UV polypropylene plastic.
- White and Brown color available.

|          | A(mm) | B(mm) | C(mm) |
|----------|-------|-------|-------|
| 4"(φ102) | 150   | 100   | 40    |
| 5"(φ127) | 200   | 125   | 60    |
| 6"(φ153) | 200   | 150   | 60    |

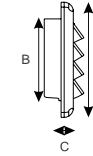

**SMS-PW**  
Plastic Vent Louver

- Designed to prevent cold air and pests entering the system when not in use.
- Modern, rounded edge with mounting holes in each corner.
- Polypropylene plastic.



**ELA**  
Stainless Vent Louver

- All stainless steel 304 construction.
- Supplied with insect mesh.

|     | A(mm) | B(mm) | C(mm) |
|-----|-------|-------|-------|
| 100 | 97    | 133   | 52    |
| 125 | 120   | 165   | 52    |
| 150 | 145   | 192   | 62    |
| 160 | 155   | 192   | 62    |
| 200 | 195   | 253   | 62    |

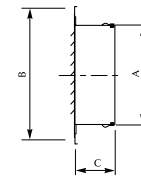

**ELC**  
Cast Aluminum Vent Louver

- Mainly used as an intake grille for fresh air.
- Manufactured of cast aluminum.

|     | φD(mm) | H(mm) |
|-----|--------|-------|
| 100 | 125    | 20    |
| 125 | 150    | 20    |
| 150 | 180    | 18    |
| 160 | 185    | 18    |
| 200 | 225    | 20    |
| 250 | 275    | 20    |
| 315 | 350    | 20    |
| 400 | 440    | 40    |

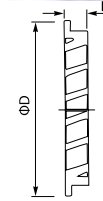

**SMS-PB**



**SMS-P**  
Plastic Vent Louver

- Modern, rounded edge with mounting holes in each corner.
- Anti-UV polypropylene plastic.
- White and Brown color available.

|          | A(mm) | B(mm) | C(mm) |
|----------|-------|-------|-------|
| 4"(φ102) | 150   | 102   | 40    |
| 5"(φ127) | 200   | 127   | 60    |
| 6"(φ153) | 200   | 152   | 60    |

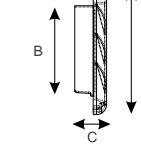

**VPPT**



**ELB**  
Aluminum Vent Louver

- External louver for air supply and exhaust.
- Made of pressed aluminium.
- Supplied with aluminium mosquito mesh.

|     | A(mm) | B(mm) | L(mm) |
|-----|-------|-------|-------|
| 80  | 80    | 103   | 50    |
| 100 | 100   | 125   | 50    |
| 125 | 125   | 150   | 50    |
| 150 | 150   | 175   | 50    |
| 160 | 160   | 188   | 50    |
| 200 | 200   | 225   | 50    |
| 250 | 250   | 275   | 50    |
| 315 | 315   | 340   | 50    |

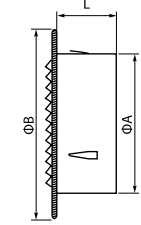

**ELF**  
Stainless Square Grille

- Easy screw fastening.
- Anti-mosquito screen.
- Good Corrosion stability.

| Size(mm) |
|----------|
| 150x150  |
| 200x200  |
| 250x250  |
| 300x300  |
| 360x360  |







**ELN**  
Stainless Vent Louver

- All stainless steel 304 construction.
- Supplied with insect mesh.

|     | A(mm) | B(mm) | C(mm) |
|-----|-------|-------|-------|
| 100 | 95    | 125   | 52    |
| 125 | 120   | 160   | 52    |
| 150 | 145   | 185   | 62    |
| 160 | 155   | 185   | 62    |

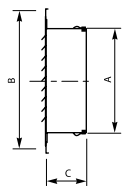

**TB**  
Rotary Chimney Cowl

- Base made of galvanized steel, cap made of stainless steel or aluminium sheet.
- For roof and chimney application.
- With or without square base.

| φD(mm) | A(mm) | B(mm) | C(mm) | H(mm) |
|--------|-------|-------|-------|-------|
| 150    | 200   | 160   | 260   | 270   |
| 200    | 250   | 220   | 300   | 300   |
| 250    | 300   | 230   | 320   | 310   |
| 300    | 350   | 250   | 350   | 330   |

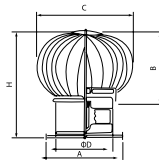

**Air Diffusers**



**CD-SB**  
Square Ceiling Diffuser

- Used for the supply and exhaust of cooled and heated air.
- Completely in extruded aluminium; satin anodized or powder-coated white RAL9010, 9016.
- The central core is removable for easy maintenance.
- Simple and pleasant appearance.
- Accessories: OBD opposite blade damper Neck adapter.
- Available in steel construction.

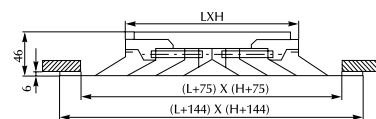

| Neck Size / Face Size     |
|---------------------------|
| 150mm×150mm / 300mm×300mm |
| 225mm×225mm / 375mm×375mm |
| 300mm×300mm / 450mm×450mm |
| 375mm×375mm / 525mm×525mm |
| 450mm×450mm / 600mm×600mm |



**CD-RA**  
Round Ceiling Diffuser

- Used for supply and exhaust of the hot or cold air.
- All aluminium construction.
- Powder-coated of anodized finish, standard colour RAL9010,9016.
- Assembled with integral butterfly volume damper made of plastic.
- The rotatable inner core offers free access to the integral butterfly plastic volume damper.

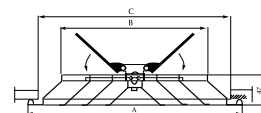

| CD-RA | A(mm) | B(mm) | C(mm) |
|-------|-------|-------|-------|
| 150   | 257   | 149   | 225   |
| 200   | 307   | 199   | 275   |
| 250   | 357   | 249   | 325   |
| 300   | 407   | 299   | 375   |
| 350   | 457   | 349   | 425   |



**CD-RD**  
Round Ceiling Diffuser

- Designed for any application requiring a high performance diffusion.
- Wide range of sizes.
- A connector, a circular volume control of opposite blades or the butterfly volume control can be attached.

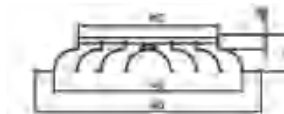

| φD | 230 | 250 | 300 | 350 | 380 | 400 | 450 | 500 | 560 | 600 | 800 | 1000 |
|----|-----|-----|-----|-----|-----|-----|-----|-----|-----|-----|-----|------|
| φC | 78  | 98  | 148 | 198 | 248 | 298 | 348 | 398 | 448 | 498 | 448 | 448  |
| φB | 165 | 180 | 230 | 280 | 335 | 380 | 425 | 495 | 535 | 590 | 690 | 580  |
| H  | 65  | 65  | 65  | 65  | 65  | 65  | 65  | 65  | 65  | 55  | 135 | 180  |



**CD-RE**  
Round Ceiling Diffuser

- Used for the supply and exhaust of cooled and heated air.
- Material: All aluminium construction.
- Colour: Powder-coated or anodized finish, standard colour RAL9010, 9016.
- Construction: Assembled with integral butterfly volume damper made of plastic.
- The rotatable inner core offers free access to the integral butterfly plastic volume damper.

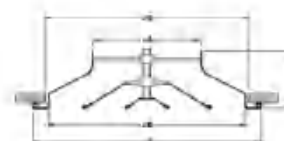

| SIZE | φA  | φC  | φB  | φH  | φD  |
|------|-----|-----|-----|-----|-----|
| 150  | 145 | 335 | 278 | 105 | 288 |
| 200  | 195 | 423 | 360 | 118 | 370 |
| 250  | 245 | 517 | 445 | 130 | 455 |
| 300  | 295 | 640 | 560 | 146 | 570 |
| 350  | 345 | 730 | 640 | 185 | 650 |



**CD-REP**  
Round Ceiling Diffuser

- Designed for T-bar ceiling: 600×600 or 610×610.
- Inner Core adjustable to control airflow volume.
- Made of aluminum sheet.
- Anodized or powder-coated, colour RAL9010, 9016, other colours on request.
- Available in Neck size: Dia 160, 200, 250



**SW**  
Swirl Ceiling Diffuser

- Swirl Diffuser SW generate high-quality, diffuse air flow according to the principle of turbulent mixing air flow.
- The diffuser SW can produce comfortable indoor air conditions.
- Low sound power level and pressure loss.
- For installation flush with suspended false ceiling or below closed false ceiling.

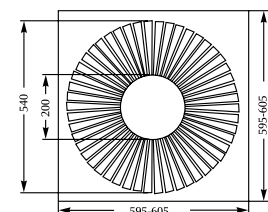

**SD-A**  
Swirl Ceiling Diffuser

- Applied to premium places and industrial workshop.
- Blow in helix, high inductivity, reduce temperature rapidly with low noise.
- With excellent performance, SD-A could be either installed flatly with the ceiling or hung on construction objects, or on the air pipe inside of enclosed ceiling.
- Both the panel and diffusing ring are painted white (RAL9010) standard.

Note: .../S/... Square face  
.../R/... Round face  
.../D/... With diffusion ring

| SIZE | A (mm) | Q1 (mm) | Q2 (mm) | R1 (mm) | R2 (mm) | H1 (mm) | H2 (mm) |
|------|--------|---------|---------|---------|---------|---------|---------|
| 200  | 198    | 600     | 600     | 241     | 300     | 50      | 120     |
| 250  | 248    | 600     | 600     | 295     | 350     | 60      | 120     |
| 315  | 313    | 600     | 600     | 364     | 450     | 60      | 125     |
| 400  | 398    | 600     | 600     | 450     | 580     | 60      | 125     |

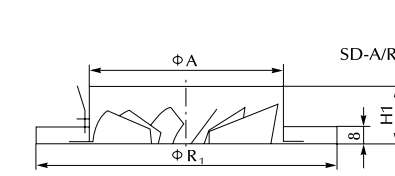
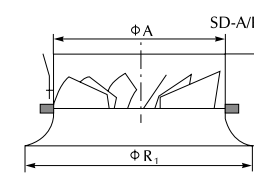
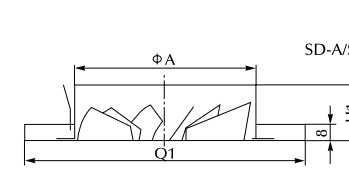
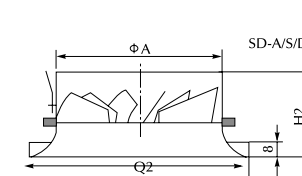

Air Diffuser and Grille

Air Diffuser and Grille

Flexible Air Duct, Plastic Air Duct

Spiral Duct and Fitting, Damper, Access Door

Ductwork Components and Accessories

Adhesive Tape, Thermal Insulation Material, Sealant

Ventilation Air Filters

Ventilation Fans



**SD-B**

Swirl Ceiling Diffuser

- SD-B swirl diffuser consist of fixed, rapidly arranged air control blades.
- The diffuser face of SD-B offers a high volume flow rate at low sound power levels.
- Available in 4 sizes to meet architectural requirements, the face plate can be circular or square.
- Square face plate are designed for T-bar ceiling.
- Powder-coated surface finish, standard colour RAL9010, 9016.

| SIZE | A(mm) | B(mm) |
|------|-------|-------|
| 300  | 595   | 254   |
| 400  | 595   | 336   |
| 500  | 595   | 440   |
| 600  | 595   | 530   |



**SD-CA**

Swirl Ceiling Diffuser

- The swirl diffuser SD-CA be used for either supply or exhaust air application.
- The diffuser be supplied with either circular or square face plate depending on architectural requirements.
- The face plate is in galvanized sheet steel, powder coated white (RAL 9010).
- Control blades are made from polystyrol, with black as stands.
- All sizes are suitable for flush mounting into a ceiling.
- Available in the sizes below.

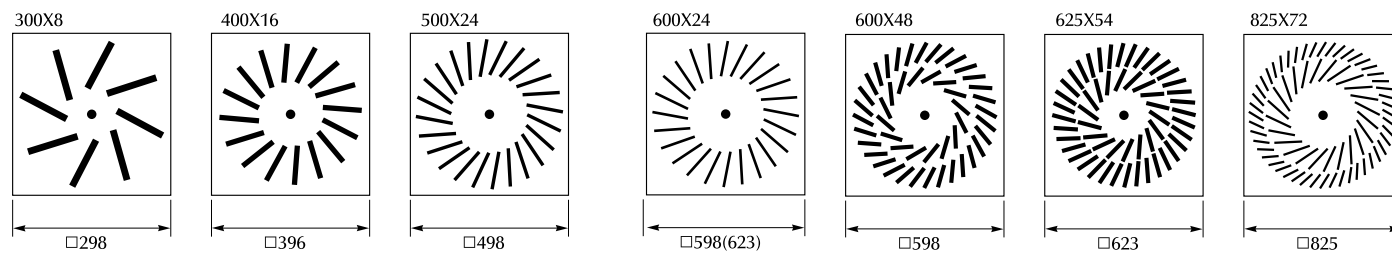

**SD-CB**

Swirl Ceiling Diffuser

- The swirl diffuser SD-CB be used for either supply or extract air application.
- The diffuser be supplied with square face plate.
- The face plate is in galvanized sheet steel, powder coated white (RAL 9010).
- Control blades are made from polystyrol, with black as standard or white on request.
- All sizes are suitable for flush mounting into a ceiling.
- Available in the sizes listed above.

| SIZE   | Dimensions | Slot numbers |
|--------|------------|--------------|
| 320x12 | 320x320    | 12           |
| 420x16 | 420x420    | 16           |
| 520x20 | 520x520    | 20           |
| 600x24 | 600x600    | 24           |
| 600x32 | 600x600    | 32           |
| 645x36 | 645x645    | 36           |
| 695x40 | 695x695    | 40           |
| 820x48 | 820x820    | 48           |

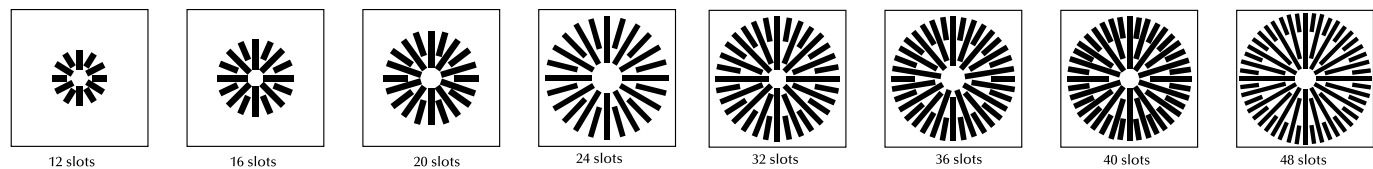

**SD-CBR**

Swirl Ceiling Diffuser

- Applied for low medium pressure ventilation systems.
- Easy to install, can be installed with a plenum box.
- Intended to operate under constant or variable air flow.
- Finish: powder coated RAL 9010, 9016.

| SIZE | φD  | Slot |
|------|-----|------|
| 400  | 400 | 16   |
| 500  | 500 | 24   |
| 600  | 600 | 32   |



**LSD**

Linear Slot Diffuser

- LSD diffusers are designed for variable air volume systems.
- Both the directions and volume of the discharged air can be adjusted, by moving the pattern controllers (see diagrams).
- Available with 1-6 slots.
- Maximum pattern controller lengths 60cm; max one piece section is 1.8m, lengths more than 1.8m are furnished in multiple sections.

| Slot No. | H       | L                                 |
|----------|---------|-----------------------------------|
| 1 Slots  | 44.5mm  | Standard L at 495mm, 990mm,       |
| 2 Slots  | 88.0mm  | 1195mm, 1495mm, 1795mm and        |
| 3 Slots  | 135.5mm | other L dimension is available at |
| 4 Slots  | 175.0mm | required.                         |

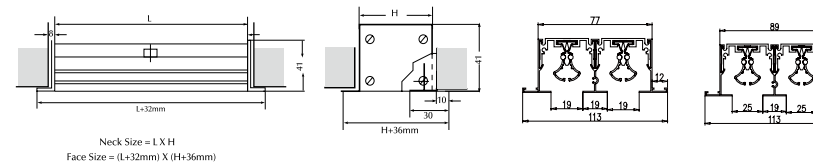

**LBD**

Linear Bar Diffuser

- Removable core separates from the frame.
- Extruded aluminium construction.
- Available in three different deflection angles: 0 degree, 15degrees, T.
- Available in standard heights ranging from 40mm up to 600mm and in single section lengths of up to 3M, depending on the height.
- Finished with power coated white or natural anodized.
- Suitable for supply and extract air in sidewall.

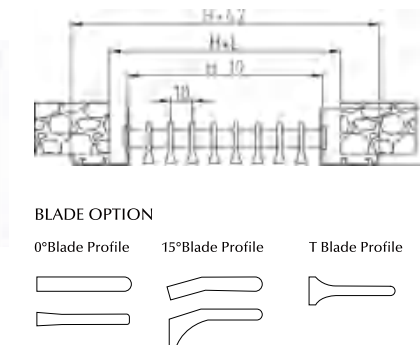

**Air Grilles**



**EG-A**

Egg Crate Grille

- Designed for return air with filter.
- Removable or hinged cores for easy access to maintenance of filter inside.
- All aluminium construction.
- 12.7mmx12.7mm or 15mmx15mm square lattice core.
- High free area: 90%, ideal for return air application.
- Powder-coated surface finish, standard colour RAL9010, 9016.
- Different sizes can be ordered on request.

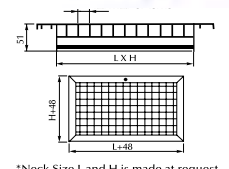

**EG-B**

Egg Crate Grille

- Designed for return air application, high free area:90%.
- All aluminium construction.
- 12.7mmx12.7mm or 15mmx15mm square lattice core.

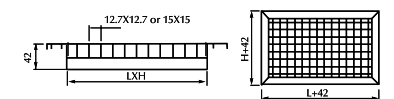

Air Diffuser and Grille

Air Diffuser and Grille

Flexible Air Duct, Plastic Air Duct

Spiral Duct and Fitting, Damper, Access Door

Ductwork Components and Accessories

Adhesive Tape, Thermal Insulation Material, Sealant

Ventilation Air Filters

Ventilation Fans



Air Diffuser and Grille

Air Diffuser and Grille



**EG-D**  
Egg Crate Grille

- Ideal for return air application.
- Light weight: all aluminium design.
- 15mm×15mm square lattice core.
- Mill finish or painted white standard RAL9010, 9016.
- For installation in false ceiling.
- Available in size: according to request.

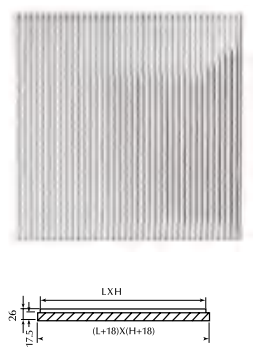

**EG-Di**  
Egg Crate Grille

- Inclined 45° fixed grid, ideal for return air application.
- Light weight: all aluminium design. 15mm×15mm square lattice core.
- Mill finish or painted white standard RAL9010, 9016.
- For installation in false ceiling, other sizes on request.



**EG-E**  
Egg Crate Grille

- Aluminium eggcrate core only.
- Mill finish, powder coated white RAL9010, 9016
- Can be easily cut to different sizes.
- Different size be produced on request.

- Egg crate core in the following configurations:
  - a) 12.7×12.7×12.7mm in thickness of 0.48mm aluminum material.
  - b) 12.7×12.7×12.7mm in thickness of 0.35mm aluminum material.
  - c) 15×15×15mm in thickness of 0.48mm aluminum material.
  - d) 15×15×12.7mm 45° inclined in thickness of 0.48mm aluminum material.
- Standard sizes:
  - 1219mm ×1219mm
  - 1200mm ×1200mm
  - 1219mm ×610mm
  - 1200mm ×600mm

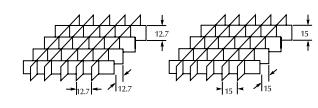

**DG-A**  
Double Deflection Grille

- Aluminium grilles, adjustable blades. Classic and popular design.
- Finish: anodized in it's natural colour or painted white RAL9010, 9016.
- Designation:
  - Vertical front blades SG-AV DG-AV
  - Horizontal front blades SG-AH DG-AH
- Mounting methods:
  - Fixing with mounting frame SFR.

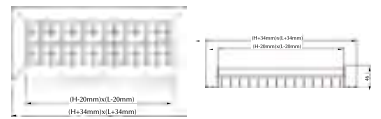

**RG-A**  
Air Return Grille

- Designed for return air.
- New and unique modern designed curved "flow-in" frames blend gently with wall or ceiling surfaces.
- All aluminium construction from precision extruded profiles.
- Available curved "flow-in" frame size: 15mm, 20mm and 30mm.
- H,L: Nominal ordering sizes (duct opening size)
- Mounting methods: Fixing with mounting frame SFR.
- Accessories and mounting:
  - Sub frame SFR
  - Volume control damper OBD
  - CLIP Mounting clips for sub frame



**WL-A**  
Weatherproof Louver

- Designed for outdoor air transfer.
- Blades have return bends at the downward which effectively prevent back flow in heavy rain and wind conditions.
- Anodized or powder coated.
- Sizes can be made to orders.

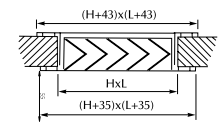

**RG-B**  
Air Return Grille

- The blades are curved and fixed with frame.
- Sizes can be produced upon request.
- Anodized or powder coated.



**TG-A**  
Door Grille

- Made from extruded aluminium.
- Anodized surface finish.
- Wall or door mounting for air transfer.
- Sizes manufactured on request.

**SGD**  
Grilles for Spiral Ducts, Single Deflection

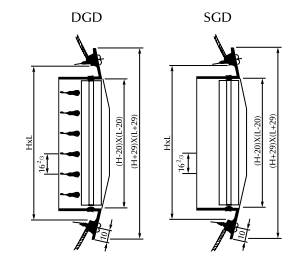

Normal Size = H X L (duct opening size)  
Neck Size = (H-20mm)X(L-20mm)  
Face Size = (H+29mm)X(L+29mm)

**DGD**  
Grilles for Spiral Ducts, Double Deflection



- Installed directly on a circular duct without frames or other fastening devices.
- Used for large locations where the circular duct is visible, e.g. in warehouse, factories, workshops, gymnasiums etc.
- Fits round ducts in dim, 150-1400mm.
- Made from galvanized steel sheet, alternatively can be supplied powder coated in RAL colour.
- The vanes can be adjusted manually and individually to obtain an optimal air distribution.
- Accessories and mounting: Inclined sliding damper Visible screw mounting.

| Dimensions LxH(mm) | φ Duct (mm) |      |
|--------------------|-------------|------|
|                    | Min.        | Max. |
| 425x75             | 150         | 400  |
| 525x75             | 150         | 400  |
| 625x75             | 150         | 400  |
| 425x125            | 315         | 900  |
| 525x125            | 315         | 900  |
| 625x125            | 315         | 900  |
| 825x125            | 315         | 900  |
| 1025x125           | 315         | 900  |
| 425x175            | 450         | 1200 |
| 525x175            | 450         | 1200 |
| 625x175            | 450         | 1200 |
| 825x175            | 450         | 1200 |
| 1025x175           | 450         | 1200 |
| 425x225            | 600         | 1400 |
| 525x225            | 600         | 1400 |
| 625x225            | 600         | 1400 |
| 825x225            | 600         | 1400 |
| 1025x225           | 600         | 1400 |



**FDS**  
Circular Swirl Floor Diffuser

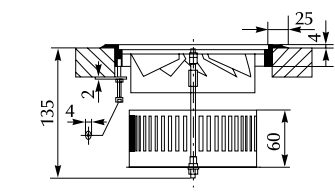
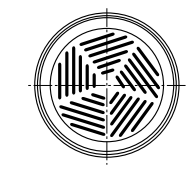

- Circular air supply diffuser with swirl function from mounting in floors.
- Diffuser manufactured in cast Aluminium, drip trap and internal swirl constructed in galvanized steel sheet.
- High induction levels.
- A cleanable diffuser.
- Sizes: φ150, φ200



**GDD**  
Spiral Ducts Grille Damper



**OBD-A**  
Opposite Blade Damper

- Made of painted steel sheet.



**OBD-B**  
Opposite Blade Damper

- Made of extruded aluminium.



**SFR**  
Sub Frame

- Provide a base for easy, quick snap-in mounting of grilles by means of the mounting springs CLIP.



**CLIP-C**  
Corner Clip



**CLIP-D**  
Damper Clip



**CLIP-M**  
Grille Fixing Clip

Flexible Air Duct, Plastic Air Duct

Spiral Duct and Fitting, Damper, Access Door

Ductwork Components and Accessories

Adhesive Tape, Thermal Insulation Material, Sealant

Ventilation Air Filters

Ventilation Fans



**Jet Nozzle**

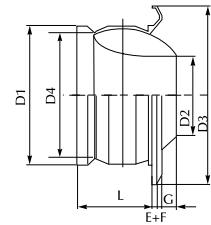

**JNS**

**Jet Nozzle**

- The nozzle and the decorative ring are manufactured in aluminium.
- Powder-coated surface finish, standard colour RAL9010, 9016.
- The connection part is made of galvanized steel sheet.
- Long distance air supply with low noise level.
- Used in superior places: concert hall, airport, theatre, museum etc.
- Available in extensive range of size.

| Specs | D1  | D3  | D2  | D4  | L   | E  | F  | G  |
|-------|-----|-----|-----|-----|-----|----|----|----|
| 100   | 98  | 148 | 60  | 70  | 85  | 8  | 8  | 6  |
| 125   | 123 | 170 | 64  | 90  | 80  | 8  | 7  | 8  |
| 160   | 158 | 210 | 85  | 130 | 98  | 9  | 14 | 8  |
| 200   | 198 | 255 | 108 | 160 | 112 | 8  | 11 | 12 |
| 250   | 248 | 301 | 136 | 208 | 143 | 10 | 15 | 13 |
| 315   | 310 | 380 | 186 | 270 | 160 | 9  | 13 | 29 |
| 400   | 396 | 467 | 230 | 350 | 182 | 11 | 11 | 55 |
| 500   | 492 | 598 | 290 | 445 | 230 | 8  | 15 | 65 |
| 630   | 625 | 700 | 295 | 585 | 295 | 25 | 50 |    |

| Specs | The proper diameter of duct |     |     |     |     |     |      |  |
|-------|-----------------------------|-----|-----|-----|-----|-----|------|--|
|       | 200                         | 250 | 315 | 500 | 630 | 800 | 1000 |  |
| 100   | ●                           |     |     |     |     |     |      |  |
| 125   |                             | ●   |     |     |     |     |      |  |
| 160   |                             |     | ●   | ●   | ●   | ●   |      |  |
| 200   |                             |     |     | ●   | ●   | ●   | ●    |  |
| 250   |                             |     |     | ●   | ●   | ●   | ●    |  |
| 315   |                             |     |     | ●   | ●   | ●   | ●    |  |
| 400   |                             |     |     |     | ●   | ●   | ●    |  |
| 500   |                             |     |     |     |     | ●   | ●    |  |

**Australian Series**



| CODE   | SIZE(mm)                     |
|--------|------------------------------|
| MSY 15 | 150.100.100                  |
| MSY 20 | 200. 150/100 150/100         |
| MSY 25 | 250. 200/150/100 200/150/100 |
| MSY 30 | 300. 250/200/150 250/200/150 |
| MSY 35 | 350. 300/250/200 300/250/200 |
| MSY 40 | 400. 350/300/250 350/300/250 |
| MSY 45 | 450. 400/350/300 400/350/300 |
| MSY 50 | 500. 450/400/350 450/400/350 |

**MSY**  
Multisnap Y

\*Code followed by 'I' for insulated fittings.

| CODE   | SIZE(mm)                                 |
|--------|--|
| MSD 20 | 200. 150/100 150/100 150/100             |
| MSD 25 | 250. 200/150/100 200/150/100 200/150/100 |
| MSD 30 | 300. 250/200/150 250/200/150 250/200/150 |
| MSD 35 | 350. 300/250/200 300/250/200 300/250/200 |

**MSD**  
Multisnap D

\*Code followed by 'I' for insulated fittings.

| CODE   | SIZE(mm)       |
|--------|----------------|
| MSB 20 | 200. 150. 150. |
| MSB 25 | 250. 200. 200. |
| MSB 30 | 300. 250. 250. |
| MSB 35 | 350. 300. 300. |
| MSB 40 | 400. 350. 350. |

**MSB**  
Multisnap B

\*Code followed by 'I' for insulated fittings.

| CODE    | SIZE(mm) |
|---------|----------|
| EYD 100 | 100      |
| EYD 150 | 150      |
| EYD 200 | 200      |
| EYD 250 | 250      |
| EYD 300 | 300      |
| EYD 350 | 350      |
| EYD 400 | 400      |

**EYD**  
NEW EZY Collar



**FC**  
Flex Collar



**FJ**  
Flex Joiner



**SV**  
Classic/Elite/Tudor

| CODE      | SIZE(mm) |
|-----------|----------|
| FC/FJ 100 | 100      |
| FC/FJ 150 | 150      |
| FC/FJ 200 | 200      |
| FC/FJ 250 | 250      |
| FC/FJ 300 | 300      |
| FC/FJ 350 | 350      |
| FC/FJ 400 | 400      |
| FC/FJ 450 | 450      |
| FC/FJ 500 | 500      |

- SMARTVENT .
- Suits all decors.
- Multiblade damper control.
- Made from impact-resistant ABS plastic.

| CODE     | SIZE            |
|----------|-----------------|
| SV 3010  | 300×100 Classic |
| SV 3515  | 350×150 Classic |
| SVR 3010 | 300×100 Elite   |
| SVT 3010 | 300×100 Tudor   |



**SVM**  
Pressed Metal

- Ideal for high traffic areas.
- Twin multi-blade damper control.
- Made from 1.2 mm high grade pressed steel.
- Powder coated gloss paint finish.
- Suits all decors.

| CODE     | SIZE                        |
|----------|-----------------------------|
| SVM 305  | 300×50 *                    |
| SVM 3010 | 300×100 *                   |
| SVA 3010 | 300×100 *Angled Air Pattern |
| SVM 355  | 350×50 *                    |
| SVM 3515 | 350×150 *                   |

Colours \*Beige Only \*Beige & White



**MJ**  
Multijet

| CODE   | SIZE(mm) | SIZE(Inch) |
|--------|----------|------------|
| MJ 150 | 150      | 6"         |
| MJ 200 | 200      | 8"         |
| MJ 250 | 250      | 10"        |
| MJ 300 | 300      | 12"        |



**DCD**  
Fullcone

| CODE    | SIZE(mm) | SIZE(Inch) |
|---------|----------|------------|
| DCD 100 | 100      | 4"         |
| DCD 125 | 125      | 5"         |
| DCD 150 | 150      | 6"         |
| DCD 200 | 200      | 8"         |
| DCD 250 | 250      | 10"        |
| DCD 300 | 300      | 12"        |



**SB/AB**  
Ducting Floor Bout



**SVP**  
Pop-up/Heritage

| CODE      | SIZE(mm)              |
|-----------|-----------------------|
| SB3010 15 | 300×100 150° Straight |
| SB3010 20 | 300×100 200° Straight |
| SB3515 20 | 350×150 200° Straight |
| SB3515 25 | 350×150 250° Straight |
| AB3010 15 | 300×100 150° Angled   |
| AB3010 20 | 300×100 200° Angled   |
| AB3515 20 | 350×150 200° Angled   |
| AB3515 25 | 350×150 250° Angled   |

- Made from impact-resistant ABS plastic.
- Suits all decors.

| CODE      | SIZE                      |
|-----------|---------------------------|
| SVP 3010  | 300×100 Pop-up            |
| SVH 3010  | 300×100 Heritage          |
| SVH 3010G | 300×100 Heritage (Gold)   |
| SVH 3010S | 300×100 Heritage (Silver) |



**SVB**  
Linear Bar

- Ideal for high traffic areas.
- Designed for add-on air conditioning systems.
- Greater free area-means more air, less noise.
- Suits floor and wall installations.
- Made from extruded aluminium profile.
- Modern slimline design.
- Arm adjustable opposed blade damper control.
- Suits all decors.
- Powder coated gloss paint finish.

| CODE     | SIZE    |
|----------|---------|
| SVB 3010 | 300×100 |
| SVB 3515 | 350×150 |
| SVB 4010 | 400×100 |

Allow for metal boots on linear bar register.



**MC**  
Multicone

| CODE   | SIZE(mm) | SIZE(Inch) |
|--------|----------|------------|
| MC 150 | 150      | 6"         |
| MC 200 | 200      | 8"         |
| MC 250 | 250      | 10"        |
| MC 300 | 300      | 12"        |



**SJ**  
Squarejet

| CODE   | SIZE(mm) | SIZE(Inch) |
|--------|----------|------------|
| SJ 100 | 100      | 4"         |
| SJ 125 | 125      | 5"         |
| SJ 150 | 150      | 6"         |
| SJ 200 | 200      | 8"         |

Air Diffuser and Grille

Air Diffuser and Grille

Flexible Air Duct, Plastic Air Duct

Spiral Duct and Fitting, Damper, Access Door

Ductwork Components and Accessories

Adhesive Tape, Thermal Insulation Material, Sealant

Ventilation Air Filters

Ventilation Fans



**MG**  
Multigrille

| CODE   | SIZE(mm) | SIZE(Inch) |
|--------|----------|------------|
| MG 150 | 150      | 6"         |
| MG 200 | 200      | 8"         |
| MG 250 | 250      | 10"        |
| MG 300 | 300      | 12"        |



**SGP**  
Slimline Return Air Grilles

| CODE      | SIZE(mm) |
|-----------|----------|
| SGP 3851  | 380x510  |
| SGP 4075  | 400x750  |
| SGP 5090  | 500x900  |
| SGP 40100 | 400x1000 |

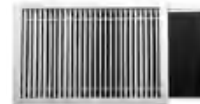

**SGF**  
Slimline Return Air Grilles

| CODE      | SIZE(mm) |
|-----------|----------|
| SGF 3851  | 380x510  |
| SGF 4075  | 400x750  |
| SGF 5090  | 500x900  |
| SGF 40100 | 400x1000 |



**SGB**  
Slimline Return Air Grilles

| CODE     | SIZE(mm)           |
|----------|--------------------|
| SGB 3737 | 370x370            |
| SGB 3720 | 370x185            |
| SGB 5326 | 530x260 T/Bar Face |
| SGB 5637 | 560x370            |
| SGB 5353 | 530/595 T/Bar Face |



**ME**  
Multivalent Eggcrate Grilles

| CODE   | SIZE                  |
|--------|-----------------------|
| ME 230 | 230x230-1 Module      |
| ME 150 | 300x150-2 Module      |
| ME 200 | 370x185-2 Module      |
| ME 260 | 560x265-2" T/Bar Face |
| ME 300 | 300x300-4 Module      |
| ME 370 | 370x370-4 Module      |
| ME 550 | 560x370-6 Module      |
| ME 595 | 530/595-4" T/Bar Face |



**MV**  
Multivalent Diffuser

| CODE    | SIZE                          |
|---------|-------------------------------|
| MV 15   | 300x150 - 2 Module            |
| MV 20   | 370x185 - 2 Module            |
| MV 26   | 530x265 - 2 Module T/Bar Face |
| MV 23 2 | 230x230 - 2 Module            |
| MV 23 4 | 230x230 - 4 Module            |
| MV 30   | 300x300 - 4 Module            |
| MV 35   | 350x350 - 4 Module            |
| MV 37   | 370x370 - 4 Module            |
| MV 45   | 450x450 - 4 Module            |
| MV 55   | 560x370 - 6 Module            |
| MV 52   | 520x350 - 6 Module T/Bar Face |
| MV TB   | 530/595 - 4 Module T/Bar Face |



**MW**  
Multivalent Grilles

| CODE  | SIZE                          |
|-------|-------------------------------|
| MW 15 | 300x150 - 2 Module            |
| MW 20 | 370x185 - 2 Module            |
| MW 26 | 530x265 - 2 Module T/Bar Face |



**MF**  
Multivalent Fixed Blade Diffuser

| CODE   | SIZE                          |
|--------|-------------------------------|
| MF 150 | 300x150 - 2 Module            |
| MF 200 | 370x185 - 2 Module            |
| MF 300 | 300x300 - 4 Module            |
| MF 370 | 370x370 - 4 Module            |
| MF 550 | 560x370 - 6 Module            |
| MF 595 | 535/595 - 4 Module T/Bar Face |



**MB**  
Insulated plastic cushion boxes

| CODE     | SIZE            |
|----------|-----------------|
| MB23D15I | 230x230 - 150mm |
| MB23D20I | 230x230 - 200mm |
| MB30D20I | 300x300 - 200mm |
| MB30D25I | 300x300 - 250mm |
| MB45D20I | 450x450 - 200mm |
| MB45D25I | 450x450 - 250mm |
| MB45D30I | 450x450 - 300mm |



**MA**  
Multivalent Adaptors

| SIZE    | With Damper |         | Without Damper |        |
|---------|-------------|---------|----------------|--------|
|         | CODE        | CODE    | CODE           | CODE   |
| 300x150 | 150         | MA15D15 |                |        |
|         | 200         | MA15D20 |                |        |
|         | 250         | MA20D20 |                |        |
| 370x185 | 200         | MA20D20 |                |        |
|         | 250         | MA20D25 |                |        |
|         | 300         | MA20D30 |                |        |
| 230x230 | 150         | MA23D15 |                |        |
|         | 200         | MA23D20 |                |        |
|         | 250         | MA23D25 |                |        |
| 530x295 | 250         | MA26D25 |                |        |
|         | 300         | MA26D30 |                | MA2630 |
|         | 350         |         |                | MA2635 |
| 300x300 | 200         | MA30D20 |                |        |
|         | 250         | MA30D25 |                |        |
|         | 300         | MA30D30 |                | MA3030 |
| 350x350 | 300         | MA35D30 |                | MA3530 |
|         | 350         |         |                | MA3535 |
|         | 400         |         |                | MA3540 |
| 370x370 | 300         | MA37D30 |                | MA3730 |
|         | 350         |         |                | MA3735 |
|         | 400         |         |                | MA3740 |
| 450x450 | 200         | MA45D20 |                |        |
|         | 250         | MA45D25 |                |        |
|         | 300         | MA45D30 |                |        |
| ...     | ...         | ...     | ...            | ...    |



**4 Way**  
Smart diffuser

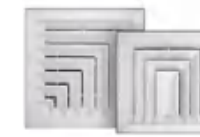

**2 Way 3Way**  
Smart diffuser

| CODE     | Neck Size / Face Size | Direction  |            |
|----------|-----------------------|------------|------------|
| SD 3525  | 230/350               | 4 way      |            |
| SDW 3525 | 230/350               | 3 way      |            |
| SDC 3525 | 230/350               | 2 way      |            |
| SD 4230  | 300/420               | 4 way      |            |
| SD 595   | 450/595               | 4 way      | T/Bar Face |
| SDP 595  | 450/595               | Perforated | T/Bar Face |



**SD595**



**SDP595**

| Neck Size (mm) | Face Size (mm) | 2 Way | 3 Way | 4 Way | Perf. | Adaptor To Flexible Duct | Cut Out Size |
|----------------|----------------|-------|-------|-------|-------|--------------------------|--------------|
| 230x230        | 360x350        | -     | -     | -     |       | 200°^ 150°^              | 295x295      |
| 300x300        | 420x420        |       |       | -     |       | 300° 250°^ 200°^         | 365x365      |
| 450x450        | 595x595*       |       |       | -     | -     | 350 300°^ 250°^ 200°^    | 540x540      |
| 360x360        | 595x595*       |       |       | -     |       | 350 300° 250° 200°       | 420x420      |

\* Suits T/Bar Ceilings    ^ Cushion Box available    \* Adaptor with twin damper blade



Plaster mounted ceiling diffusers come with EZY-SNAP mounting clips



**JM602R**  
Plastic T/Bar Diffuser

| CODE    | SIZE    |
|---------|---------|
| JM 602R | 360/595 |



**JM602R Adaptors**  
With Butterfly Damper

| CODE | SIZE          |
|------|---------------|
| A20D | 360x360 - 200 |
| A25D | 360x360 - 250 |
| A30D | 360x360 - 300 |
| A35  | 360x360 - 350 |





**Eggcrate Grilles**

| CODE    | NECK SIZE      |
|---------|----------------|
| ECA 100 | 100            |
| ECA 125 | 125            |
| ECA 150 | 150            |
| ECA 200 | 200            |
| ECA 250 | 250            |
| OAE 125 | 125 Fixed Face |
| OAE 150 | 150 Fixed Face |



**Louver Grilles**

| CODE    | NECK SIZE        |
|---------|------------------|
| LCA 100 | 100              |
| LCA 125 | 125              |
| LCA 150 | 150              |
| LCA 200 | 200              |
| LCA 250 | 250              |
| OAL 125 | 125 Fixed Louver |
| OAL 150 | 150 Fixed Louver |



**Louver Grilles**

| CODE     | SIZE(inch) | Neck Size (mm) |
|----------|------------|----------------|
| 24GYE05S | 2"         | 50             |
| 24GYE10S | 4"         | 100            |
| 24GYC05S | 2"         | 50             |
| 24GYC10S | 4"         | 100            |



**Wall Ventilation LED**

| CODE  | SIZE(inch) | Neck Size (mm) |
|-------|------------|----------------|
| WVL 4 | 4"         | 100            |
| WVL 5 | 5"         | 125            |
| WVL 6 | 6"         | 150            |

**American Series**



**1CB**  
Curved Blade One Way Register



- All steel construction.
- Stamped curved-blade supply register with multi-louver damper for ceiling or sidewall application.
- One piece stamped face and 1" curved blade lanced.
- One way deflection.
- White powder-coating finish.
- Any color you would like.

**2CB**  
Curved Blade Two Way Register



- All steel construction.
- Stamped curved-blade supply register with multi-louver damper for ceiling or sidewall application.
- One piece stamped face and 1" curved blade lanced.
- Two way deflection.
- White powder-coating finish.
- Any color you would like( 2 weeks more).

**3CB**  
Curved Blade Three Way Register



- All steel construction.
- Stamped curved-blade supply register with multi-louver damper for ceiling or sidewall application.
- One piece stamped face and 1" curved blade lanced.
- Three way deflection.
- White powder-coating finish.
- Any color you would like( 2 weeks more).

**4CB**  
Curved Blade Four Way Register



- All steel construction.
- Stamped curved-blade supply register with multi-louver damper for ceiling or sidewall application.
- One piece stamped face and 1" curved blade lanced.
- Four way deflection.
- White powder-coating finish.
- Any color you would like( 2 weeks more).

**1SW**  
One Way Register



- All steel construction.
- Used for ceiling or sidewall installations and ideal for shallow duct installations.
- 1/2" spaced fins set at 40 degrees and 1-5/8" depth when fully opened.
- Multi-shutter valve.
- One way deflection.
- White powder-coating finish.
- Any color you would like.

**2SW**  
Two Way Register



- All steel construction.
- Used for ceiling or sidewall installations and ideal for shallow duct installations.
- 1/2" spaced fins set at 40 degrees and 1-5/8" depth when fully opened.
- Multi-shutter valve.
- Two way deflection.
- White powder-coating finish.
- Any color you would like.

Air Diffuser and Grille

Air Diffuser and Grille

Flexible Air Duct, Plastic Air Duct

Spiral Duct and Fitting, Damper, Access Door

Ductwork Components and Accessories

Adhesive Tape, Thermal Insulation Material, Sealant

Ventilation Air Filters

Ventilation Fans

**3SW**

Three Way Register

- All steel construction.
- Used for ceiling or sidewall installations and ideal for shallow duct installations.
- 1/2" spaced fins set at 40 degrees and 1-5/8" depth when fully opened.
- Multi-shutter valve.
- Three way deflection.
- White powder-coating finish.
- Any color you would like.



**4SW**

Four Way Register

- All steel construction.
- Used for ceiling or sidewall installations and ideal for shallow duct installations.
- 1/2" spaced fins set at 40 degrees and 1-5/8" depth when fully opened.
- Multi-shutter valve.
- Four way deflection.
- White powder-coating finish.
- Any color you would like.



**CSF**

Contemporary Steel Floor Register

- For floor application in home restoration or new construction.
- Lever operated, multi-shutter steel valve with louvers.
- Stamped steel construction.
- Contemporary style face, two-way air flow pattern.
- Brass plated, Brush Nickel are available.



**4CSD**

Ceiling Square Diffuser

- Steel construction.
- High capacity design.
- 2" Standard inlet collar with turned edge.
- Circular air pattern.
- Available with steel damper.
- Available with foil backed insulation.
- White finish.
- Fixed cone design.



**110M**

Air Register

- All steel construction.
- Vertical front bars and horizontal second bars.
- Adjustable face bars may be set to any desired deflection.
- Multi-shutter damper.
- Large sizes available in multiple-piece construction.
- Bright white finish.



**FL**

Floor Register

- Used for floor ventilation application.
- All steel construction.
- Multi-angle fin setting.
- Rolled fin for strength and safety.
- Heavy gauge stamped face and welded.
- Foot-operated dial control.
- White or brown powder-coating finish.
- Any color you would like.



**1RAF**

Return Air Filter Grille With Frame

- For air return application.
- 1/3" spaced fins.
- Exceptional free area.
- 5/16" Margin turn back.
- White powder-coating finish.



**1RA**

Return Air Grille

- For air return application.
- 1/3" spaced fins.
- Exceptional free area.
- 5/16" Margin turn back.
- White powder-coating finish.



**BRA**

Baseboard Return Air Grille

- All steel construction.
- 7/8" margin turn back and exceptional free area.
- Install with fins upward or downward for best duct concealment.
- White powder-coating finish.
- Any color you would like.



**BB**

Baseboard Diffuser

- All stamped steel construction.
- Front row of adjustable blades are set on 3/4" centers.
- Designed to blanket walls and windows from baseboard installations.
- Lever operated multi-louver damper provide exacting volume control.
- Snap in face for ease of installation.
- Rear damper blades for volume control on 1" spacing.
- Available in 15" and 18" length.
- Finish: Bright White(W) or golden Sand(GS) enamel.



**CAD**

Cone Air Diffuser

- Stamped steel face construction.
- Three-cone provide 360 degree maximum air diffusion.
- For ceiling air diffusion application.
- Round face.
- Bright white finish.



**VF**

Victorian Floor Register

- For floor application in home restoration or new construction.
- Lever operated, multi-shutter steel valve with louvers.
- Stamped steel construction and Victorian style.
- Brass plated, Brush Nickel are available.





Flexible Air Duct



PVC FABRIC

Flexible Air Duct Clamp and Connector



Flat Air Duct



Rectangular Plastic Duct and Fittings



Flexible Air Duct



ALU Aluminum Flexible Duct

- Full range of flexible uninsulated multiply aluminum / polyester laminated ducting for HVAC market.
- Made of multi-layer aluminum / polyester laminate with embedded flexible wire spring for different needs of operating temperature.
- Ideal for use in general purpose exhaust applications and ventilation of central air-con system.
- Max air Velocity: 30 Meter / Sec (6000ft / min); Max air pressure: 250mm W.G.

| Properties       | Alu 2.0                  | Alu 3.0                  | Alu 6.0                  |
|------------------|--------------------------|--------------------------|--------------------------|
| Diameter         | 50mm-610mm               | 50mm-610mm               | 50mm-610mm               |
| Temperature      | -30/150 C                | -30/150 C                | -30/220 C                |
| Max Air Velocity | 30m/sec                  | 30m/sec                  | 30m/sec                  |
| Pressure         | 2500Pa                   | 3000Pa                   | 3000Pa                   |
| Standard Length  | 10m                      | 10m                      | 10m                      |
| Packing          | Individual carton        | Individual carton        | Individual carton        |
| Layer            | 1 polyester & 1 aluminum | 1 polyester & 2 aluminum | 2 polyester & 4 aluminum |
| Certificate      | CE                       | CE                       | CE                       |



ISO Aluminum Insulated Flexible Duct

- Full range of flexible thermal insulated ducting for preventing condensation then there's temperature difference in airflow of ventilation system.
- Helpful for reducing heat & cool loss and preventing condensation.
- Insulation: standard 16kg/m<sup>3</sup> glass wool and 32kg/m<sup>3</sup> glass wool is also available.
- Packing: individual 120cm long carton packing or Individual PE bag packing.

| Properties       | Iso 2.0        | Iso 3.0        | Iso 6.0        |
|------------------|----------------|----------------|----------------|
| Inner duct       | AluAir+2.0     | AluAir+3.0     | AluAir+6.0     |
| Outer Jacket     | Alu Jacket 1.0 | Alu Jacket 1.0 | Alu Jacket 1.0 |
| Diameter         | 50mm-610mm     | 50mm-610mm     | 50mm-610mm     |
| Temperature      | -30/140 C      | -30/140 C      | -30/140 C      |
| Max Air Velocity | 30m/sec        | 30m/sec        | 30m/sec        |
| Pressure         | 2500Pa         | 3000Pa         | 3000Pa         |
| Standard Length  | 10m            | 10m            | 10m            |
| Certificate      | CE             | CE             | CE             |

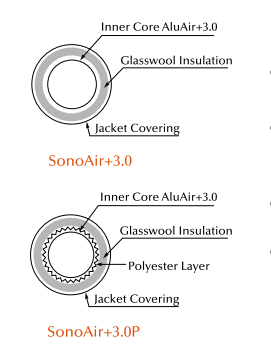

SONO Aluminum Acoustic Insulated Flexible Duct

- Full range of flexible acoustic thermal insulated ducting for preventing condensation and reducing noise when there's temperature difference in airflow of ventilation system.
- Helpful for reducing heat & cool loss and preventing condensation.
- Insulation: standard 16kg/m<sup>3</sup> quality insulation glass wool and 32kg/m<sup>3</sup> glass wool is also available.
- Perforated aluminum/polyester lamination for reducing noise.
- Packing: individual 120cm long carton packing or Individual PE bag packing.

| Properties       | Sono 2.0       | Sono 3.0       |
|------------------|----------------|----------------|
| Inner duct       | AluAir+2.0     | AluAir+3.0     |
| Outer Jacket     | Alu Jacket 1.0 | Alu Jacket 1.0 |
| Polyester Layer  | /              | /              |
| Diameter         | 50mm-610mm     | 50mm-610mm     |
| Temperature      | -30/140 C      | -30/140 C      |
| Max Air Velocity | 30m/sec        | 30m/sec        |
| Pressure         | 2500Pa         | 3000Pa         |
| Standard Length  | 10m            | 10m            |
| Certificate      | CE             | CE             |

| Properties       | Sono 3.0P      | Sono 6.0P      |
|------------------|----------------|----------------|
| Inner duct       | AluAir+3.0     | AluAir+6.0     |
| Outer Jacket     | Alu Jacket 1.0 | Alu Jacket 1.0 |
| Polyester Layer  | yes            | yes            |
| Diameter         | 50mm-610mm     | 50mm-610mm     |
| Temperature      | -30/140 C      | -30/140 C      |
| Max Air Velocity | 30m/sec        | 30m/sec        |
| Pressure         | 3000Pa         | 3000Pa         |
| Standard Length  | 10m            | 10m            |
| Certificate      | CE             | CE             |

Flexible Air Duct, Plastic Air Duct

Air Diffuser and Grille

Flexible Air Duct, Plastic Air Duct

Spiral Duct and Fitting, Damper, Access Door

Ductwork Components and Accessories

Adhesive Tape, Thermal Insulation Material, Sealant

Ventilation Air Filters

Ventilation Fans



**COMBI**  
Aluminum & PVC Combined Flexible Duct

- Combined with an aluminum / polyester laminated inter core and a mechanical resistant PVC layer, COMBI Duct is good for some special industrial use Such as the exhaust of welding fumes.

| Properties       | COMBI                  |
|------------------|------------------------|
| Inner Duct       | AluAir+Light/ pvc foil |
| Diameter         | 50mm-610mm             |
| Temperature      | -30 C /140 C           |
| Max Air Velocity | 30m/ sec               |
| Pressure         | 2500Pa                 |
| Standard Length  | 10m                    |
| Packing          | individual carton      |



**POLY**  
Polyester Flexible Duct

- Made of one layer polyester foil and one layer metalized polyester which is stronger and prevent lights inside and is especially good for garden ventilation system.

| Properties  | POLY         |
|-------------|--------------|
| Size        | 45mm-610mm   |
| Length      | 25ft (7.6m)  |
| Temperature | -30 C /150 C |



**PVC**  
PVC Flexible Duct

| Properties       | PVC          | PVC Fabric           |
|------------------|--------------|----------------------|
| Inner Duct       | PVC foil     | PVC foil/glass cloth |
| Diameter         | 50mm-610mm   | 50mm-610mm           |
| Temperature      | -30 C /140 C | -30 C /140 C         |
| Max Air Velocity | 30m/ sec     | 30m/ sec             |
| Pressure         | 2500Pa       | 2500Pa               |
| Standard Length  | 10m          | 10m                  |
| Packing          | /            | individual carton    |



**PVC Fabric**  
PVC Fabric Flexible Duct

- Non-insulated polyester ducting is made of multi layer metalized polyester or polyester and is designed for ventilation system at medium to low pressure.



**POLY ISO**  
Polyester Insulated Flexible Duct

- Harmless for the environment and human being.
- The main market for POLY ISO is Australia and New Zealand.

\* Polyester fibre blend or Insulation glass wool.

| Properties           | POLY ISO                      |
|----------------------|-------------------------------|
| Jacket               | 2ply black polyester air duct |
| Size                 | 45mm-610mm                    |
| Length               | 25ft (7.6m)                   |
| Temperature range    | -30/150 C                     |
| Insulation Thickness | 25mm                          |
| Insulation Density   | 16kg/m <sup>3</sup>           |



**POLYM**  
Metallized Polyester Flexible Duct

- Made of one layer aluminum foil and one layer of polyester which is stronger and prevent lights inside and is especially good for garden ventilation system.

| Properties  | POLYM        |
|-------------|--------------|
| Size        | 45mm-610mm   |
| Length      | 25ft (7.6m)  |
| Temperature | -30 C /150 C |



**SEMI**  
Semi Rigid Flexible Duct

- Aluminum Semi Flexible Air Duct, extendable and highly reliable for low and medium pressure air conditioning , ventilation, boiler systems and chimney liners.
- SEMI is elastic, flexible and stretchable.
- Oval and circular connectors are easily installed.

| Properties          | SEMI             |
|---------------------|------------------|
| Fire Resistance     | Non-combustible  |
| Construction        | 1 ply aluminium  |
| Nominal Thickness   | 90 micron        |
| Available Diameters | φ80mm-φ800m      |
| Temperature Range   | -25 C /+250 C    |
| Air Velocity        | 25m/s(max)       |
| Operating Pressure  | 2000Pa(max)      |
| Standard Length     | 1.5m/ 3.0m/ 6.0m |
| Compression Ratio   | 1/3              |

| Properties  | PVC FABRIC   |
|-------------|--------------|
| Diameter    | 45mm - 610mm |
| Length      | 25ft (7.6m)  |
| Temperature | -30 C /150 C |



Flexible Air Duct Clamp and Connector



Type A



Type B

**CLB**  
Clamp Band



- Comes with a handy plastic container having 30m strip inside and with multi clamp, you may cut it to any size fitting different size flexible ducts.
- Band: 9mm width, 0.6mm thickness with rounded edges and smooth underside of banding, preventing any risk of damage to the duct being clamped.
- Band material: Stainless(SS) steel AISI 430 or Galvanized Steel.



**SCL**  
Speed Clamp

- Made of 9mm stainless steel strip, with suitably profiled edges preventing duct damage during fixing.
- Ideal for all types of flexible duct and suitable for different size with different length strip.
- Size: 90mm-660mm

| Type    | Max. Dia  |
|---------|-----------|
| SCL 90  | 060-090mm |
| SCL 110 | 060-110mm |
| SCL 135 | 060-135mm |
| SCL 165 | 060-165mm |
| SCL 180 | 060-180mm |
| SCL 215 | 060-215mm |
| SCL 270 | 060-270mm |
| SCL 325 | 060-325mm |
| SCL 380 | 060-380mm |
| SCL 525 | 060-525mm |
| SCL 660 | 060-660mm |



**MCL**  
Band Lock

- Packing: 50pcs / bag

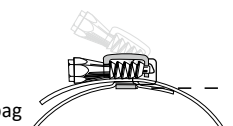

**NCL**  
Nylon Clamp

- NCL nylon clamp is an economic alternative for metal bands when installing flexible ducts.
- Easy to install, make the work much faster and hold the duct securely on the connector pipe.
- Nylon bands can be used within the temperature range: -55 C to +100 C .
- They are available in lengths ranging from 550mm to 1188mm.
- If other lengths are required, the bands can be easily connected without using any tools.



**ACL**  
American Type Hose Clamp

- Size: 1/2"to 8" (13mm-178mm)
- Band Material: SS201,301,304, carbon steel



**GCL**  
German Type Hose Clamp

- The hose clamp is subject to strong resistance, high pressure resistance, corrosion resistance.
- Coated: galvanize, chromeplate, nickel-plate.
- With minus recessed screw and philips head screw.
- Bend width: 9mm or 12mm.
- Bend material: SS201,301,304,carbon steel



PCO-A



PCO-B

**PCO**  
Plenum Collar (Sleeve with Flange)

- Plenum Collar is made of steel sheet.
- Connect the plenum box with the pipes.
- Available in the dimensions below: 100,125,150,160,200,250,300,350, 400mm and more.



Flat Air Duct

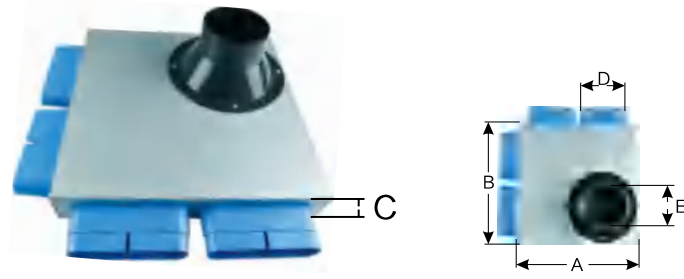

Floor Supply Air branch 1 divide 4

| TYPE       | SIZE(mm) |     |    |     |    |
|------------|----------|-----|----|-----|----|
|            | A        | B   | C  | D   | E  |
| Branch 1-4 | 320      | 320 | 52 | 132 | 97 |

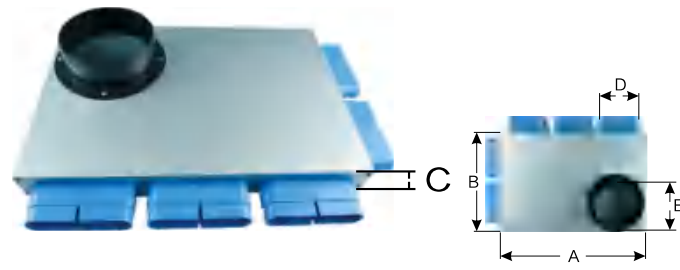

Floor Supply Air branch 1 divide 5

| TYPE       | SIZE(mm) |     |    |     |     |
|------------|----------|-----|----|-----|-----|
|            | A        | B   | C  | D   | E   |
| Branch 1-5 | 470      | 320 | 52 | 132 | 147 |



Floor Supply Air branch 1 divide 6

| TYPE       | SIZE(mm) |     |    |     |     |
|------------|----------|-----|----|-----|-----|
|            | A        | B   | C  | D   | E   |
| Branch 1-6 | 620      | 320 | 52 | 132 | 147 |

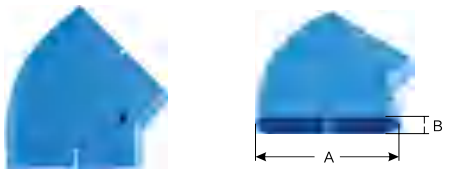

Floor Supply Air Bend 45°

| TYPE     | SIZE(mm) |    |
|----------|----------|----|
|          | A        | B  |
| Bend 45° | 132      | 30 |

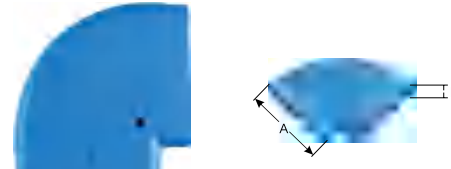

Floor Supply Air Bend 90°

| TYPE     | SIZE(mm) |    |
|----------|----------|----|
|          | A        | B  |
| Bend 90° | 132      | 30 |

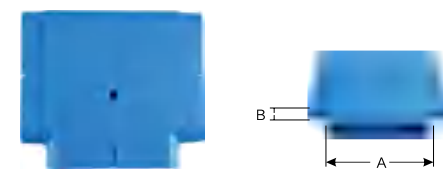

Floor Supply Air Tee

| TYPE | SIZE(mm) |    |
|------|----------|----|
|      | A        | B  |
| Tee  | 132      | 30 |

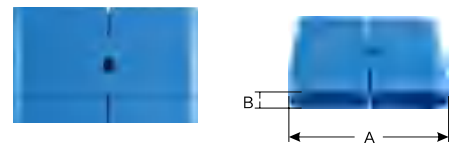

Floor Supply Air Joint

| TYPE  | SIZE(mm) |    |
|-------|----------|----|
|       | A        | B  |
| Joint | 132      | 30 |

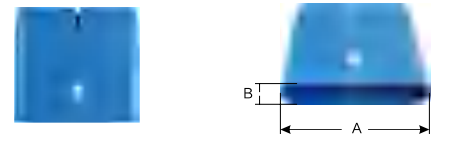

Air regulating damper

| TYPE   | SIZE(mm) |    |
|--------|----------|----|
|        | A        | B  |
| Damper | 132      | 30 |

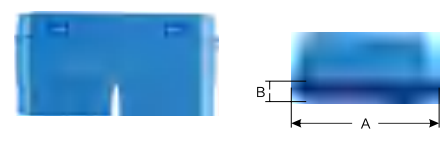

Box Joint

| TYPE      | SIZE(mm) |    |
|-----------|----------|----|
|           | A        | B  |
| Box Joint | 132      | 30 |



Wall Corner 45° Bend

| TYPE     | SIZE(mm) |    |
|----------|----------|----|
|          | A        | B  |
| Bend 45° | 132      | 30 |

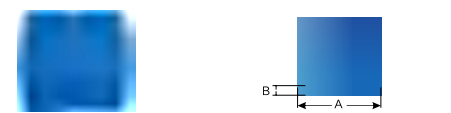

Wall Corner 90° Bend

| TYPE     | SIZE(mm) |    |
|----------|----------|----|
|          | A        | B  |
| Bend 90° | 132      | 30 |



Round to Flat

| TYPE          | SIZE(mm) |    |    |
|---------------|----------|----|----|
|               | A        | B  | C  |
| Round to Flat | 132      | 30 | 75 |



End cap

| TYPE    | SIZE(mm) |    |
|---------|----------|----|
|         | A        | B  |
| End cap | 132      | 30 |

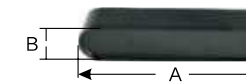

Flat Duct

| TYPE      | SIZE(mm) |    |
|-----------|----------|----|
|           | A        | B  |
| Flat Duct | 132      | 30 |

Rectangular Plastic Duct and Fittings



DT

Duct

Size: 204x60mm, 220x90mm, 350x75mm



DCT

Duct Connector



DCP

Duct Clip



VB45

Vertical Bend 45 deg.



VB90

Vertical Bend 90 deg.



HB45

Horizontal Bend 45 deg



HB90

Horizontal Bend 90 deg



CBR

90 deg Connecting Bend with Reducer To-Round



LAR

Long Adaptor To-Round



TEE

Tee

Spiral Duct and Fitting



Duct Damper

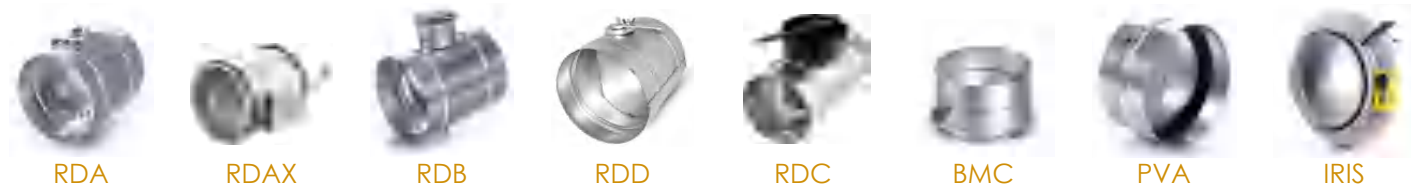

Quadrants



Access Door



Damper Actuator



Spiral Duct and Fitting

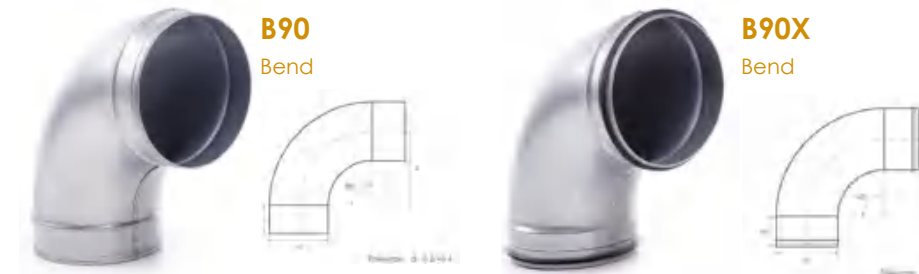

| SIZE | d     | A   | H  |
|------|-------|-----|----|
| 80   | 78.9  | 100 | 40 |
| 100  | 98.9  | 100 | 40 |
| 125  | 123.9 | 125 | 40 |
| 150  | 148.9 | 150 | 40 |
| 160  | 158.9 | 160 | 40 |
| 180  | 178.9 | 180 | 40 |
| 200  | 198.9 | 200 | 40 |



| SIZE | d     | A   | H  |
|------|-------|-----|----|
| 80   | 78.9  | 100 | 40 |
| 100  | 98.9  | 100 | 40 |
| 125  | 123.9 | 125 | 40 |
| 150  | 148.9 | 150 | 40 |
| 160  | 158.9 | 160 | 40 |
| 180  | 178.9 | 180 | 40 |
| 200  | 198.9 | 200 | 40 |

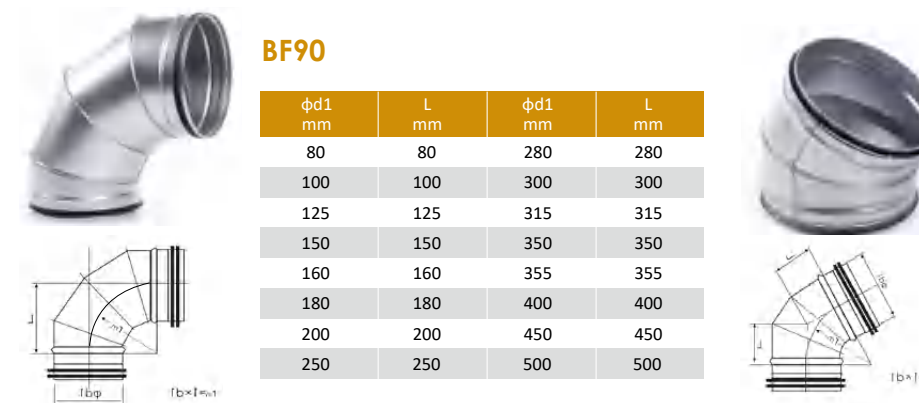

| φd1 mm | L mm | φd1 mm | L mm |
|--------|------|--------|------|
| 80     | 80   | 280    | 280  |
| 100    | 100  | 300    | 300  |
| 125    | 125  | 315    | 315  |
| 150    | 150  | 350    | 350  |
| 160    | 160  | 355    | 355  |
| 180    | 180  | 400    | 400  |
| 200    | 200  | 450    | 450  |
| 250    | 250  | 500    | 500  |

| φd1 mm | L mm | φd1 mm | L mm |
|--------|------|--------|------|
| 80     | 33   | 280    | 116  |
| 100    | 41   | 300    | 124  |
| 125    | 52   | 315    | 131  |
| 150    | 62   | 350    | 145  |
| 160    | 66   | 355    | 147  |
| 180    | 74   | 400    | 166  |
| 200    | 83   | 450    | 186  |
| 250    | 104  | 500    | 207  |



| SIZE | D   |
|------|-----|
| 100  | 98  |
| 125  | 123 |
| 150  | 148 |
| 160  | 158 |
| 200  | 198 |



**RC Reducer**



| SIZE    | D     | d     | L   | H  | L2 |
|---------|-------|-------|-----|----|----|
| 100 80  | 98.8  | 78.8  | 110 | 40 | 55 |
| 125 80  | 123.8 | 78.8  | 122 | 40 | 55 |
| 125 100 | 123.8 | 98.8  | 112 | 45 | 55 |
| 150 100 | 148.7 | 98.8  | 125 | 45 | 55 |
| 150 125 | 148.7 | 123.8 | 122 | 45 | 55 |
| 160 100 | 158.7 | 98.8  | 130 | 45 | 55 |
| 160 125 | 158.7 | 123.8 | 117 | 45 | 55 |
| 200 100 | 198.6 | 98.8  | 150 | 45 | 55 |
| 200 125 | 198.6 | 123.8 | 137 | 45 | 55 |
| 200 150 | 198.6 | 148.7 | 125 | 45 | 55 |
| 200 160 | 198.6 | 158.7 | 120 | 45 | 55 |
| 250 160 | 248.5 | 158.7 | 144 | 45 | 55 |
| 250 200 | 248.5 | 198.6 | 125 | 45 | 55 |
| 315 160 | 313.4 | 158.7 | 177 | 45 | 55 |
| 315 200 | 313.4 | 198.6 | 157 | 45 | 55 |
| 315 150 | 313.4 | 248.5 | 132 | 45 | 55 |
| 355 250 | 353.4 | 248.5 | 200 | 45 | 45 |
| 355 315 | 353.4 | 313.4 | 160 | 50 | 50 |

Technical drawing showing dimensions: D, d, L, H, L2.

**RCX Reducer**



| SIZE    | D     | d     | L   | H  | L2 |
|---------|-------|-------|-----|----|----|
| 100 80  | 98.8  | 78.8  | 100 | 35 | 50 |
| 125 80  | 123.8 | 78.8  | 112 | 35 | 50 |
| 125 100 | 123.8 | 98.8  | 102 | 40 | 50 |
| 150 100 | 148.7 | 98.8  | 115 | 40 | 50 |
| 150 125 | 148.7 | 123.8 | 112 | 40 | 50 |
| 160 100 | 158.7 | 98.8  | 120 | 40 | 50 |
| 160 125 | 158.7 | 123.8 | 107 | 40 | 50 |
| 200 100 | 198.6 | 98.8  | 140 | 40 | 50 |
| 200 125 | 198.6 | 123.8 | 127 | 40 | 50 |
| 200 150 | 198.6 | 148.7 | 115 | 40 | 50 |
| 200 160 | 198.6 | 158.7 | 110 | 40 | 50 |
| 250 160 | 248.5 | 158.7 | 134 | 40 | 50 |
| 250 200 | 248.5 | 198.6 | 115 | 40 | 50 |
| 315 160 | 313.4 | 158.7 | 167 | 40 | 50 |
| 315 200 | 313.4 | 198.6 | 147 | 40 | 50 |
| 315 150 | 313.4 | 248.5 | 122 | 40 | 50 |
| 355 250 | 353.4 | 248.5 | 190 | 40 | 40 |
| 355 315 | 353.4 | 313.4 | 150 | 45 | 45 |

Technical drawing showing dimensions: D, d, L, H, L2.

**RCF Reducer**



| SIZE    | D     | d     | L   | H  |
|---------|-------|-------|-----|----|
| 100 80  | 100.5 | 78.8  | 110 | 40 |
| 125 80  | 125.5 | 78.8  | 122 | 40 |
| 125 100 | 125.5 | 98.8  | 112 | 45 |
| 150 100 | 150.6 | 98.8  | 125 | 45 |
| 150 125 | 150.6 | 123.8 | 122 | 45 |
| 160 100 | 160.6 | 98.8  | 130 | 45 |
| 160 125 | 160.6 | 123.8 | 117 | 45 |
| 200 100 | 200.7 | 98.8  | 150 | 45 |
| 200 125 | 200.7 | 123.8 | 137 | 45 |
| 200 150 | 200.7 | 148.7 | 125 | 45 |
| 200 160 | 200.7 | 158.7 | 120 | 45 |
| 250 160 | 250.8 | 158.7 | 144 | 45 |
| 250 200 | 250.8 | 198.6 | 125 | 45 |
| 315 160 | 315.9 | 158.7 | 177 | 45 |
| 315 200 | 315.9 | 198.6 | 157 | 45 |
| 315 150 | 315.9 | 248.5 | 132 | 45 |
| 355 250 | 356   | 248.5 | 200 | 45 |
| 355 315 | 356   | 313.4 | 160 | 50 |

Technical drawing showing dimensions: D, d, L, H.

**RCFX Reducer**



| SIZE    | D     | d     | L   | H  |
|---------|-------|-------|-----|----|
| 100 80  | 100.5 | 78.8  | 105 | 35 |
| 125 80  | 125.5 | 78.8  | 117 | 55 |
| 125 100 | 125.5 | 98.8  | 107 | 40 |
| 150 100 | 150.6 | 98.8  | 120 | 40 |
| 150 125 | 150.6 | 123.8 | 117 | 40 |
| 160 100 | 160.6 | 98.8  | 125 | 40 |
| 160 125 | 160.6 | 123.8 | 112 | 40 |
| 200 100 | 200.7 | 98.8  | 145 | 40 |
| 200 125 | 200.7 | 123.8 | 132 | 40 |
| 200 150 | 200.7 | 148.7 | 120 | 40 |
| 200 160 | 200.7 | 158.7 | 115 | 40 |
| 250 160 | 250.8 | 158.7 | 139 | 40 |
| 250 200 | 250.8 | 198.6 | 120 | 40 |
| 315 160 | 315.9 | 158.7 | 172 | 40 |
| 315 200 | 315.9 | 198.6 | 152 | 40 |
| 315 150 | 315.9 | 248.5 | 127 | 40 |
| 355 250 | 356   | 248.5 | 195 | 40 |
| 355 315 | 356   | 313.4 | 155 | 45 |

Technical drawing showing dimensions: D, d, L, H.

**V Coupling**



| SIZE | d     | H  |
|------|-------|----|
| 80   | 78.8  | 45 |
| 100  | 98.8  | 45 |
| 125  | 123.8 | 45 |
| 150  | 148.7 | 45 |
| 160  | 158.7 | 45 |
| 180  | 178.6 | 45 |
| 200  | 198.6 | 45 |
| 250  | 248.5 | 45 |
| 300  | 298.4 | 45 |
| 315  | 313.4 | 45 |
| 355  | 353.3 | 45 |
| 400  | 398.3 | 45 |

Technical drawing showing dimensions: d, H.

**VX Coupling**



| SIZE | d     | H  |
|------|-------|----|
| 80   | 78.8  | 40 |
| 100  | 98.8  | 40 |
| 125  | 123.8 | 40 |
| 150  | 148.7 | 40 |
| 160  | 158.7 | 40 |
| 180  | 178.6 | 40 |
| 200  | 198.6 | 40 |
| 250  | 248.5 | 40 |
| 300  | 298.4 | 40 |
| 315  | 313.4 | 40 |
| 355  | 353.3 | 40 |
| 400  | 398.3 | 40 |

Technical drawing showing dimensions: d, H.

**VF Coupling**



| SIZE | d     | H  |
|------|-------|----|
| 80   | 80.5  | 45 |
| 100  | 100.5 | 45 |
| 125  | 125.5 | 45 |
| 150  | 150.6 | 45 |
| 160  | 160.6 | 45 |
| 180  | 180.6 | 45 |
| 200  | 200.7 | 45 |
| 250  | 250.8 | 45 |
| 300  | 300.9 | 45 |
| 315  | 315.9 | 45 |
| 355  | 356.0 | 45 |
| 400  | 401.0 | 45 |

Technical drawing showing dimensions: d, H.

**VXH Coupling**



| SIZE | d     | H1 | H2 |
|------|-------|----|----|
| 80   | 78.8  | 40 | 45 |
| 100  | 98.8  | 40 | 45 |
| 125  | 123.8 | 40 | 45 |
| 150  | 148.7 | 40 | 45 |
| 160  | 158.7 | 40 | 45 |
| 180  | 178.6 | 40 | 45 |
| 200  | 198.6 | 40 | 45 |
| 250  | 248.5 | 40 | 45 |
| 300  | 298.4 | 40 | 45 |
| 315  | 313.4 | 40 | 45 |
| 355  | 353.3 | 40 | 45 |
| 400  | 398.3 | 40 | 45 |

Technical drawing showing dimensions: d, H1, H2.

**IL Take-off**



| SIZE | d     | H  | R |
|------|-------|----|---|
| 80   | 78.8  | 45 | 4 |
| 100  | 98.8  | 45 | 4 |
| 125  | 123.8 | 45 | 4 |
| 150  | 148.7 | 45 | 4 |
| 160  | 158.7 | 45 | 4 |
| 200  | 198.6 | 45 | 4 |
| 250  | 248.5 | 45 | 4 |
| 315  | 313.4 | 45 | 4 |
| 355  | 353.3 | 45 | 4 |
| 400  | 398.3 | 45 | 4 |

Technical drawing showing dimensions: d, H, R.

**ILX Take-off**



| SIZE | d     | H  | R |
|------|-------|----|---|
| 80   | 78.8  | 40 | 4 |
| 100  | 98.8  | 40 | 4 |
| 125  | 123.8 | 40 | 4 |
| 150  | 148.7 | 40 | 4 |
| 160  | 158.7 | 40 | 4 |
| 200  | 198.6 | 40 | 4 |
| 250  | 248.5 | 40 | 4 |
| 315  | 313.4 | 40 | 4 |
| 355  | 353.3 | 40 | 4 |
| 400  | 398.3 | 40 | 4 |

Technical drawing showing dimensions: d, H, R.

**ILR Take-off**



| SIZE | d     | H  | R  |
|------|-------|----|----|
| 80   | 78.8  | 45 | 12 |
| 100  | 98.8  | 45 | 15 |
| 125  | 123.8 | 45 | 20 |
| 150  | 148.7 | 45 | 20 |
| 160  | 158.7 | 45 | 25 |
| 200  | 198.6 | 45 | 25 |
| 250  | 248.5 | 45 | 25 |
| 315  | 313.4 | 45 | 25 |

Technical drawing showing dimensions: d, H, R.

**ILRX Take-off**



| SIZE | d     | H  | R  |
|------|-------|----|----|
| 80   | 78.8  | 40 | 12 |
| 100  | 98.8  | 40 | 15 |
| 125  | 123.8 | 40 | 20 |
| 150  | 148.7 | 40 | 20 |
| 160  | 158.7 | 40 | 25 |
| 200  | 198.6 | 40 | 25 |
| 250  | 248.5 | 40 | 25 |
| 315  | 313.4 | 40 | 25 |

Technical drawing showing dimensions: d, H, R.

**D End Cap**



| SIZE | d     | H  | R |
|------|-------|----|---|
| 80   | 78.8  | 20 | 5 |
| 100  | 98.8  | 20 | 5 |
| 125  | 123.8 | 20 | 5 |
| 150  | 148.7 | 20 | 5 |
| 160  | 158.7 | 20 | 5 |
| 180  | 178.6 | 20 | 5 |
| 200  | 198.6 | 20 | 5 |
| 250  | 248.5 | 20 | 5 |
| 315  | 313.4 | 20 | 5 |
| 355  | 353.4 | 20 | 5 |
| 400  | 398.4 | 20 | 5 |

Technical drawing showing dimensions: d, H, R.

**DF End Cap**



| SIZE | d     | H  | R |
|------|-------|----|---|
| 80   | 80.5  | 40 | 4 |
| 100  | 100.5 | 40 | 4 |
| 125  | 125.5 | 40 | 4 |
| 150  | 150.6 | 40 | 4 |
| 160  | 160.6 | 40 | 4 |
| 180  | 180.6 | 40 | 4 |
| 200  | 200.7 | 40 | 4 |
| 250  | 250.8 | 40 | 4 |
| 315  | 315.9 | 40 | 4 |
| 355  | 356.0 | 40 | 4 |
| 400  | 401.0 | 40 | 4 |

Technical drawing showing dimensions: d, H, R.



**PS**  
Collar Saddle

| SIZE    | D   | d     | H  | B  | R  |
|---------|-----|-------|----|----|----|
| 100 100 | 100 | 98.8  | 40 | 32 | 12 |
| 125 100 | 125 | 98.8  | 40 | 32 | 12 |
| 160 100 | 160 | 98.8  | 40 | 32 | 12 |
| 200 100 | 200 | 98.8  | 40 | 32 | 12 |
| 125 125 | 125 | 123.8 | 40 | 32 | 12 |
| 160 125 | 160 | 123.8 | 40 | 32 | 12 |
| 200 125 | 200 | 123.8 | 40 | 32 | 12 |
| 250 125 | 250 | 123.8 | 40 | 32 | 12 |
| 160 160 | 160 | 158.7 | 40 | 36 | 16 |
| 200 160 | 200 | 158.7 | 40 | 36 | 16 |
| 200 200 | 200 | 198.6 | 40 | 50 | 20 |



**PSX**  
Collar Saddle

| SIZE    | D   | d     | H  | B  | R  |
|---------|-----|-------|----|----|----|
| 100 100 | 100 | 98.8  | 40 | 32 | 12 |
| 125 100 | 125 | 98.8  | 40 | 32 | 12 |
| 160 100 | 160 | 98.8  | 40 | 32 | 12 |
| 200 100 | 200 | 98.8  | 40 | 32 | 12 |
| 125 125 | 125 | 123.8 | 40 | 32 | 12 |
| 160 125 | 160 | 123.8 | 40 | 32 | 12 |
| 200 125 | 200 | 123.8 | 40 | 32 | 12 |
| 250 125 | 250 | 123.8 | 40 | 32 | 12 |
| 160 160 | 160 | 158.7 | 40 | 36 | 16 |
| 200 160 | 200 | 158.7 | 40 | 36 | 16 |
| 200 200 | 200 | 198.6 | 40 | 50 | 20 |



**YP**  
Y-pieces

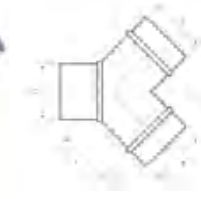

**YPX**  
Y-pieces

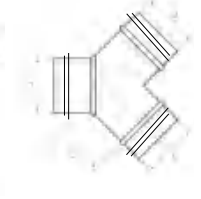

| SIZE    | D     | d     | L   |
|---------|-------|-------|-----|
| 100 80  | 98.8  | 78.8  | 130 |
| 100 100 | 98.8  | 98.8  | 140 |
| 125 100 | 123.8 | 98.8  | 150 |
| 125 125 | 123.8 | 123.8 | 170 |
| 160 100 | 158.7 | 98.8  | 195 |
| 160 125 | 158.7 | 123.8 | 200 |
| 160 160 | 158.7 | 158.7 | 205 |
| ...     | ...   | ...   | ... |



**TP**  
T-pieces

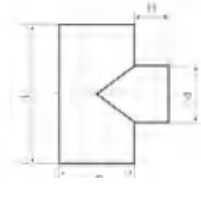

**TPX**  
T-pieces

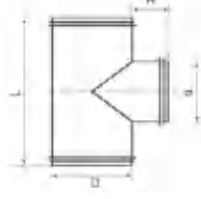

| SIZE    | D     | d     | L   | H   |
|---------|-------|-------|-----|-----|
| 100 80  | 98.8  | 78.8  | 140 | 45  |
| 100 100 | 98.8  | 98.8  | 160 | 45  |
| 125 80  | 123.8 | 78.8  | 140 | 45  |
| 125 100 | 123.8 | 98.8  | 160 | 45  |
| 125 125 | 123.8 | 123.8 | 200 | 45  |
| 150 80  | 148.7 | 78.8  | 140 | 45  |
| 150 100 | 148.7 | 98.8  | 160 | 45  |
| ...     | ...   | ...   | ... | ... |



**SD**  
Spiral Duct

| φD mm | T mm | φD mm | T mm | φD mm | T mm | φD mm | T mm |
|-------|------|-------|------|-------|------|-------|------|
| 80    | 0.6  | 280   | 0.6  | 550   | 0.8  | 1100  | 1.0  |
| 100   | 0.6  | 300   | 0.6  | 600   | 0.8  | 1200  | 1.0  |
| 125   | 0.6  | 315   | 0.6  | 630   | 0.8  | 1250  | 1.0  |
| 150   | 0.6  | 350   | 0.6  | 650   | 0.8  | 1300  | 1.0  |
| 160   | 0.6  | 355   | 0.6  | 700   | 0.8  | 1350  | 1.2  |
| 180   | 0.6  | 400   | 0.8  | 800   | 0.8  | 1400  | 1.2  |
| 200   | 0.6  | 450   | 0.8  | 600   | 1.0  | 1450  | 1.2  |
| 250   | 0.6  | 500   | 0.8  | 1000  | 1.0  | 1500  | 1.2  |



**FB**  
Filter Box for Round Duct

- The box filter cassette is fitted with a standard type EU3 panel filter.
- Manufactured from galvanized sheet steel with rubber sealed circular connections, toggle locks and disposable filters.
- Replacement air filter is also available.
- The filter cassette is suitable for use as a supply is filter in heavy industry and industrial workshops.
- The recommended final pressure drop is 170 Pa for the EU3 filter.



**FRD**  
Round Duct Filter

- FRD round duct filter is used for initial filtration of flowing air in round duct systems.
- Filtering element is an EU4 class inset secured with a galvanized net.
- Cover is made from galvanized steel with gaskets on both ends.
- Construction ensures easy and fast assembly.

| TYPE   | D mm | L mm | E mm |
|--------|------|------|------|
| FRD100 | 100  | 120  | 40   |
| FRD125 | 125  | 120  | 40   |
| FRD160 | 160  | 120  | 40   |
| FRD200 | 200  | 120  | 40   |
| FRD250 | 250  | 120  | 40   |
| FRD315 | 315  | 120  | 40   |
| FRD355 | 355  | 120  | 40   |
| FRD400 | 400  | 140  | 50   |
| FRD500 | 500  | 140  | 50   |



**RS**  
Round Duct Silencer

| SIZE | φd  | φD  | L    | SIZE | φd  | φD  | L    |
|------|-----|-----|------|------|-----|-----|------|
| 100  | 100 | 200 | 300  | 200  | 200 | 315 | 300  |
| 100  | 100 | 200 | 600  | 200  | 200 | 315 | 600  |
| 100  | 100 | 200 | 900  | 200  | 200 | 315 | 900  |
| 100  | 100 | 200 | 1200 | 200  | 200 | 315 | 1200 |
| 125  | 125 | 224 | 300  | 250  | 250 | 355 | 600  |
| 125  | 125 | 224 | 600  | 250  | 250 | 355 | 900  |
| 125  | 125 | 224 | 900  | 250  | 250 | 355 | 1200 |
| 125  | 125 | 224 | 1200 | 315  | 315 | 500 | 600  |
| 160  | 160 | 280 | 300  | 315  | 315 | 500 | 900  |
| 160  | 160 | 280 | 600  | 315  | 315 | 500 | 1200 |
| 160  | 160 | 280 | 900  | 400  | 400 | 600 | 600  |
| 160  | 160 | 280 | 1200 | 400  | 400 | 600 | 900  |

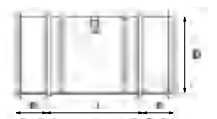

Duct Damper



**RDA**



**RDAX**



**RDB**



**RDBX**

Regulating Damper

- Galvanized steel.
  - EPDM (DSX) rubber gasket.
  - Branching connection.
  - Fusion welded (linear weld).
- Possibility of use for different types of mechanism.

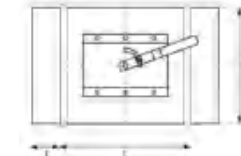

Regulating Damper

- Designed to admit an insulation thickness of up to 50mm.
- The damper blade can be adjusted on the shaft within a range of 0° to 90°, The blade can be locked using a screw.

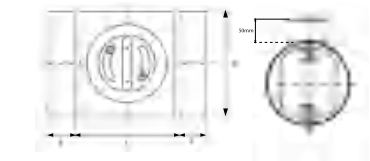

| D(mm) | L(mm) | E(mm) |
|-------|-------|-------|
| 100   | 110   | 30    |
| 125   | 110   | 30    |
| 150   | 110   | 30    |
| 160   | 110   | 30    |
| 200   | 110   | 30    |
| 250   | 140   | 40    |
| 315   | 140   | 40    |

| D(mm) | L(mm) | E(mm) |
|-------|-------|-------|
| 100   | 100   | 40    |
| 125   | 100   | 40    |
| 150   | 100   | 40    |
| 160   | 100   | 40    |
| 200   | 100   | 40    |
| 250   | 100   | 40    |
| 315   | 100   | 40    |



**RDD**

Regulating Damper

- Position of the damper plane is visible on a handle within 0° to +90°.
- The damper plane can be fixed by means of a bolt with a wing-nut weight.

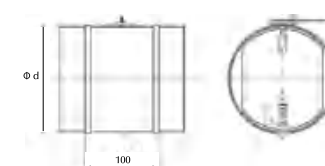



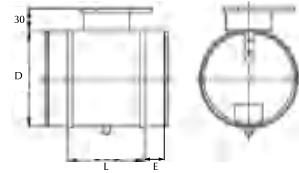

| D(mm) | L(mm) | E(mm) |
|-------|-------|-------|
| 80    | 100   | 40    |
| 100   | 100   | 40    |
| 125   | 100   | 40    |
| 140   | 100   | 40    |
| 150   | 100   | 40    |
| 160   | 100   | 40    |
| 180   | 100   | 40    |
| 200   | 100   | 40    |
| 225   | 100   | 40    |
| 250   | 100   | 40    |
| 280   | 100   | 40    |
| ...   | ...   | ...   |

**RDC**

**Regulating Damper**

- The RDC damper construction enables to use up to 30mm insulation.
- Position of the damper plane is visible on a handle within 0° to 90°.
- The damper plane can be fixed by means of a bolt. Ends are made with a safe edge.

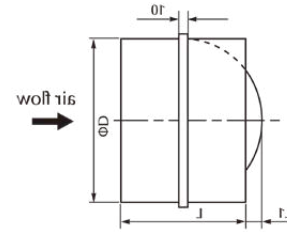

**BM**

**Bellmouth Spigot Plain**

**BMC**

**Bellmouth Spigot with Balancing Damper**



- Light weight, strong and stackable for convenient storage and transport.
- Uniquely designed with 'DUCT LANCES' to help secure flexible duct.
- Sizes: 100mm, 150mm, 200mm, 250mm, 300mm, 350mm, 400mm, 450mm, 500mm diameters.

**PVA**

**Back Draught Damper**

- The pressure relief valve PVA is used for preventing the reverse of air flow in circular duct systems.
- The casing of PVA is made from galvanized steel, the blades are made of aluminium.
- With a inner foam seal for better tightness and noise reducing.
- The valve opens when overpressure occurs and closes by means of spring when the pressure drops.
- It is recommended to install the shutter into horizontal duct.

| Model | φD  | L1  | L   |
|-------|-----|-----|-----|
| 100   | 96  | 6   | 88  |
| 125   | 121 | 19  | 88  |
| 150   | 146 | 31  | 88  |
| 160   | 155 | 36  | 88  |
| 200   | 197 | 56  | 88  |
| 250   | 247 | 61  | 128 |
| 315   | 312 | 94  | 128 |
| 355   | 352 | 65  | 198 |
| 400   | 397 | 64  | 198 |
| 450   | 447 | 80  | 248 |
| 500   | 497 | 107 | 248 |

**IRIS**

**Iris Damper**

- With the IRIS damper the intensity of air flow may be continuously adjusted.
- Adjustment is done with a handle on the damper which changes the diameter of the opening which may be used to connect.
- Instrumentation measuring the intensity of air flow.
- Also supplied with a gasket which tightens the connection with the system.

| Art. No  | Art Flow |          | Dimension |     |     |    |
|----------|----------|----------|-----------|-----|-----|----|
|          | min m³/h | Max m³/h | mm        |     |     |    |
|          | 35dB(A)  | 55dB(A)  | d         | D   | L   | A  |
| IRIS 100 | 40       | 270      | 99        | 165 | 110 | 30 |
| IRIS 125 | 60       | 400      | 124       | 188 | 110 | 30 |
| IRIS 160 | 120      | 600      | 159       | 230 | 110 | 30 |
| IRIS 200 | 270      | 1100     | 199       | 285 | 110 | 30 |
| IRIS 250 | 280      | 1600     | 249       | 335 | 135 | 35 |
| IRIS 315 | 400      | 2500     | 314       | 410 | 135 | 35 |

**RDF**

**Regulating Damper**

- 5mm foil backed insulation.
- Sizes: 150mm, 200mm, 250mm, 300mm, 350mm, 400mm, 450mm, 500mm.



**Quadrants**



**DR20**

**Damper Quadrant**

- 1/4" and 3/8" dial regulator are the most popular models on the market.
- Minimize air leakage and reduce rattle. A wing nut locks the damper in position.
- The dial shows the damper position at a glance.
- Can be mounted easily on round or rectangular ducts.
- For dampers up to: 250mm (10") Diameter
- Set Includes: Dial parts with handle (1/4" spring loaded end spindle) Wing nut, washer&bolt (1/4" spring loaded end spindle 1/4"Square spindle)



**DR30**

**Damper Quadrant**

- For dampers up to : 500mm (20") Diameter
- Set Includes: Dial parts with handle (3/8" spring loaded end spindle) Wing nut, washer&bolt (3/8"Square spindle)



**DQS60**

**Damper Quadrant**

- For dampers up to : 700mm (30") Diameter.
- Set Includes: Quadrant Handle Wing nut, washer & bolt 1/2" Square spindle 1/2" Round spindle



**DQS75**

**Damper Quadrant**

- For multi-blade dampers with round shaft of 12mm (1/2") Diameter.
- Set Includes: Quadrant Handle Wing nut, washer & bolt Packing: 50 sets per carton



**DB**

**Damper Blade**

- Plain damper blade, grooved damper blade.
- Galvanized steel, carbon steel, etc.
- Spring bearing, solid bearing, stud.
- Size available in 150mm to 450mm.



**PSR**

**Plastic Damper Regulator**

- Made of Nylon material.
- Very easy to handle.
- It is recommended for round or square duct up to 250mm (10").
- Can be applied for damper blade thickness max. 1mm.



**DR-K**

**Rapid Damper Regulator**

- Set includes: Handle Short clip bearing Long clip bearing Wing nut and washer Packing: 100 sets per carton



**DR-M**

**Rapid Damper Regulator**

- For dampers up to: 250mm (10") Diameter
- Set includes: Handle Wing nut, washer and bolt Spring loaded end spindle Oval threaded spindle Packing: 100 sets per carton



**Stand Off**

**Stand Off Damper Regulator**



Access Door



**CAD-A**  
Curved Access Door

- Designed for trouble-free access to volume and fire control dampers, associated ventilation and air conditioning equipment mounted within ductwork.
- Coming with a self adhesive template helping measuring on the spiral duct.
- Door panels are available in aluminium and stainless steel to special order.

| Size        | Dia       |
|-------------|-----------|
| 180mm×80mm  | ≤125mm    |
| 250mm×150mm | 150/160mm |
| 250mm×150mm | 180/200mm |
| 250mm×150mm | 250mm     |
| 250mm×150mm | 300/315mm |
| 250mm×150mm | 355mm     |
| 250mm×150mm | 400mm     |
| 400mm×300mm | 450mm     |
| 400mm×300mm | 500mm     |
| 400mm×300mm | 560mm     |
| 400mm×300mm | 630mm     |
| 400mm×300mm | 710/800mm |



**CAD-B**  
Curved Access Door

- Designed for trouble-free access to volume control and fire dampers.
- Every access door is coming with a self-adhesive template helping measuring on the spiral duct.

| Specification (mm) |                               |
|--------------------|-------------------------------|
| 180mm×80mm         | φ100/125<br>φ160<br>φ200      |
| 250mm×150mm        | φ150/160<br>.....<br>φ450/500 |
| 300mm×200mm        | φ315/355<br>.....<br>φ450/500 |
| 400mm×300mm        | φ400/450<br>.....<br>φ710/800 |



**FAD-A**  
Flat Access Door

- Material: Galvanized steel DX51 D+Z 275 and Galvanized steel DX51 D+Z 80 are available.
- Gasket: cellular sponge gasket.
- Locking Knob color: usually red and blue color available.
- Bolts/nuts: Mild steel and Zn coating.

| Size        |
|-------------|
| 200mm×100mm |
| 300mm×150mm |
| 300mm×200mm |
| 400mm×300mm |
| 500mm×300mm |
| 500mm×400mm |
| 600mm×500mm |

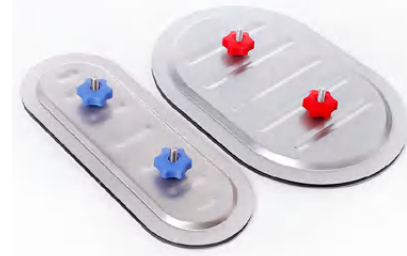

**FAD-B**  
Flat Access Door

- Material: Galvanized steel DX51 D+Z 275 and Galvanized steel DX51 D+Z 80 are available.
- Gasket: cellular sponge gasket.
- Locking Knob color: usually red and blue color available.
- Bolts/nuts: Mild steel and Zn coating.

| Size        |
|-------------|
| 180mm×80mm  |
| 200mm×100mm |
| 250mm×150mm |
| 300mm×200mm |
| 400mm×300mm |
| 500mm×400mm |
| 600mm×450mm |



**FAD-C**  
Flat Access Door

- Used as an easy resealable way of gaining access to rigid air conditioning ducts and conditioner housings for equipment maintenance and cleaning purposes.
- Designed for ease of operation. Simply turn the galvanized steel sash came provided on the panel to un-lock then remove from its frame.



**FAD-D**  
Flat Access Door

- Material: 22ga (0.85) galvanized door panel and flanged frame (Die-formed).
- Hinge: Plated steel camlock fasteners.
- Insulation: 1" (25) Styrofoam with a 22ga galvanized backing plate.
- Monting: 3/16" (5) dia. pre-punched holes on inner flange for surface mounting.
- Application: Adaptable to all Ducts 5" (127) or Over.
- Template: Layout template included on each box.

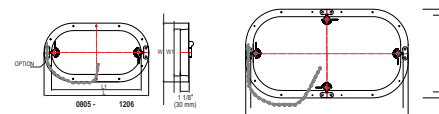

| Model | Nominal Size             | L1                 | W1                 | LW                 |                    |
|-------|--------------------------|--------------------|--------------------|--------------------|--------------------|
| 0805  | 8"×5"<br>(200mm×125mm)   | 5 1/8"<br>(205mm)  | 5"<br>(129mm)      | 9 1/2"<br>(241mm)  | 6 1/2"<br>(165mm)  |
| 1206  | 12"×6"<br>(300mm×150mm)  | 12 1/8"<br>(309mm) | 6 1/2"<br>(158mm)  | 13 3/4"<br>(349mm) | 7 3/4"<br>(198mm)  |
| 1810  | 18"×10"<br>(460mm×250mm) | 18 1/2"<br>(462mm) | 10 1/4"<br>(260mm) | 19 3/4"<br>(502mm) | 11 7/8"<br>(300mm) |
| 2114  | 21"×14"<br>(530mm×360mm) | 21 1/4"<br>(540mm) | 14 1/8"<br>(360mm) | 13 7/8"<br>(580mm) | 15 3/4"<br>(400mm) |
| 2517  | 25"×17"<br>(635mm×430mm) | 25 1/8"<br>(640mm) | 17 1/4"<br>(438mm) | 26 3/4"<br>(680mm) | 19 7/8"<br>(478mm) |



**TAD-A**  
Tabbed Access Door

- Designed to provide access to all in-duct equipment for inspection, maintenance and cleaning.
- All doors are of double-skin construction, using 0.8mm galvanized steel enclosing 25mm 60kg/m2 fibreglass insulation.
- A flame retardant gasket fixed to the door reduces the risk of air leakage.
- A positive seal is achieved by the use of camlock fasteners.

| Size        | Size        |
|-------------|-------------|
| 100mm×100mm | 400mm×400mm |
| 150mm×150mm | 450mm×300mm |
| 200mm×125mm | 450mm×450mm |
| 200mm×200mm | 500mm×500mm |
| 250mm×250mm | 600mm×300mm |
| 300mm×150mm | 600mm×400mm |
| 300mm×200mm | 600mm×450mm |
| 300mm×300mm | 600mm×600mm |
| 400mm×300mm |             |



**TAD-B**  
Tabbed Access Door

- Frame thickness: 1.0mm
- Curved frame is one piece construction without mitres or welds.
- Use concealed piano hinge and cylinder lock.
- RAL 9016 as standard, other colors on request.

| Specification | Neck size   | Overall size |
|---------------|-------------|--------------|
| 200mm×200mm   | 195mm×195mm | 235mm×235mm  |
| .....         | .....       | .....        |
| 600mm×600mm   | 595mm×595mm | 635mm×635mm  |



**TAD-C**  
Tabbed Access Door

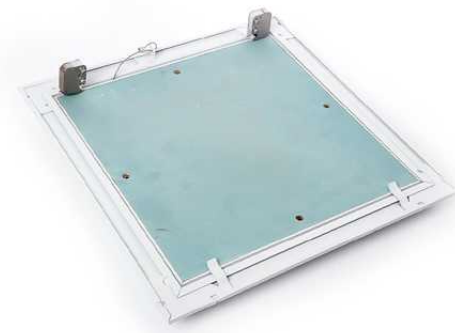

**TAD-D**  
Tabbed Access Door

### Damper Actuator



**SJ series**  
Standard Angular Travel Actuator

| Model            | Output Torque | Supply Voltage | Running Time | Control Signal   | Optional Auxiliary Switch      |
|------------------|---------------|----------------|--------------|------------------|--------------------------------|
| SJ0224/230-K/K F | 2N            | 24V/230V       | 20-25S       | Switch control   | A set of auxiliary switches    |
| SJ0224/230-M/M F | 2N            | 24V/230V       | 20-25S       | 0/2-10v 0/4-20MA | A set of auxiliary switches    |
| SJ0424/230-K/K F | 4N            | 24V/230V       | 25-30S       | Switch control   | Two sets of auxiliary switches |
| SJ0424/230-M/M F | 4N            | 24V/230V       | 25-30S       | 0/2-10v 0/4-20MA | Two sets of auxiliary switches |
| SJ0624/230-K/K F | 6N            | 24V/230V       | 25-30S       | Switch control   | Two sets of auxiliary switches |
| SJ0624/230-M/M F | 6N            | 24V/230V       | 25-30S       | 0/2-10v 0/4-20MA | Two sets of auxiliary switches |
| SJ0824/230-K/K F | 8N            | 24V/230V       | 30-45S       | Switch control   | Two sets of auxiliary switches |
| SJ0824/230-M/M F | 8N            | 24V/230V       | 30-45S       | 0/2-10v 0/4-20MA | Two sets of auxiliary switches |
| SJ1624/230-K/K F | 16N           | 24V/230V       | 30-45S       | Switch control   | Two sets of auxiliary switches |
| SJ1624/230-M/M F | 16N           | 24V/230V       | 30-45S       | 0/2-10v 0/4-20MA | Two sets of auxiliary switches |
| SJ2424/230-K/K F | 24N           | 24V/230V       | 120-160S     | Switch control   | Two sets of auxiliary switches |
| SJ2424/230-M/M F | 24N           | 24V/230V       | 120-160S     | 0/2-10v 0/4-20MA | Two sets of auxiliary switches |
| SJ3224/230-K/K F | 32N           | 24V/230V       | 160-200S     | Switch control   | Two sets of auxiliary switches |
| SJ3224/230-M/M F | 32N           | 24V/230V       | 160-200S     | 0/2-10v 0/4-20MA | Two sets of auxiliary switches |
| SJ4024/230-K/K F | 40N           | 24V/230V       | 200-220S     | Switch control   | Two sets of auxiliary switches |
| SJ4024/230-M/M F | 40N           | 24V/230V       | 200-220S     | 0/2-10v 0/4-20MA | Two sets of auxiliary switches |



**FSJ series**  
Fast Angular Travel Actuator

| Model             | Output Torque | Supply Voltage | Running Time | Control Signal   | Optional Auxiliary Switch      |
|-------------------|---------------|----------------|--------------|------------------|--------------------------------|
| FSJ0524/230-K/K F | 5N            | 24V/230V       | 3.5S         | Switch control   | A set of auxiliary switches    |
| FSJ0524/230-M/M F | 5N            | 24V/230V       | 3.5S         | 0/2-10v 0/4-20MA | A set of auxiliary switches    |
| FSJ0824/230-K/K F | 8N            | 24V/230V       | 8S           | Switch control   | Two sets of auxiliary switches |
| FSJ0824/230-M/M F | 8N            | 24V/230V       | 8S           | 0/2-10v 0/4-20MA | Two sets of auxiliary switches |
| FSJ1624/230-K/K F | 16N           | 24V/230V       | 16S          | Switch control   | Two sets of auxiliary switches |
| FSJ1624/230-M/M F | 16N           | 24V/230V       | 16S          | 0/2-10v 0/4-20MA | Two sets of auxiliary switches |
| FSJ2424/230-K/K F | 24N           | 24V/230V       | < 30S        | Switch control   | Two sets of auxiliary switches |
| FSJ2424/230-M/M F | 24N           | 24V/230V       | < 30S        | 0/2-10v 0/4-20MA | Two sets of auxiliary switches |
| FSJ4024/230-K/K F | 40N           | 24V/230V       | < 30S        | Switch control   | Two sets of auxiliary switches |
| FSJ4024/230-M/M F | 40N           | 24V/230V       | < 30S        | 0/2-10v 0/4-20MA | Two sets of auxiliary switches |



**TSJ series**  
Spring Return Angular Travel Actuator

| Model        | Output Torque | Supply Voltage | Running Time | Reset Time | Control Signal | Optional Auxiliary Switch      |
|--------------|---------------|----------------|--------------|------------|----------------|--------------------------------|
| TSJ0524-K    | 5N            | 24V            | 3.5S         | 3.5S       | Switch control | /                              |
| TSJ0524-K F  | 5N            | 24V            | 3.5S         | 3.5S       | Switch control | Two sets of auxiliary switches |
| TSJ05230-K   | 5N            | 230V           | 8S           | 8S         | Switch control | /                              |
| TSJ05230-K F | 5N            | 230V           | 8S           | 8S         | Switch control | Two sets of auxiliary switches |



Ductwork Hangers and Support



Support Channel Fittings and Brackets

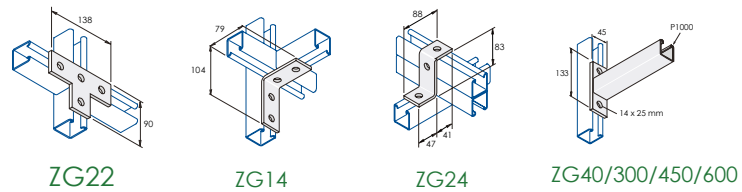

Ductwork Assembly



Fasteners



Ductwork Hangers and Support



**SCP-A**  
Spiral Duct Clamp

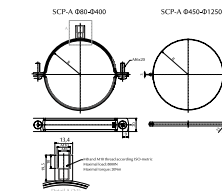

- Used for suspension of rigid circular ducts.
- Dia 80 up to 400mm with screw M6 on either side, 1-point suspension with M8/M10 nut on top.
- Dia 450 up to 800mm with 2-point suspension with M10 hole on either side.
- It ensures fast assembly thanks to an easy system of locking and tightening.
- Version with a gasket prevents the transmission of vibrations from the system to the building's structure.

| Size | T   | Connection nut | Size | T   | Connection nut |
|------|-----|----------------|------|-----|----------------|
| 80   | 1,5 | M8+M10         | 280  | 1,5 | M8+M10         |
| 100  | 1,5 | M8+M10         | 300  | 1,5 | M8+M10         |
| 125  | 1,5 | M8+M10         | 315  | 1,5 | M8+M10         |
| 140  | 1,5 | M8+M10         | 355  | 1,5 | M8+M10         |
| 150  | 1,5 | M8+M10         | 400  | 1,5 | M8+M10         |
| 160  | 1,5 | M8+M10         | 450  | 2,5 | M10            |
| 180  | 1,5 | M8+M10         | 500  | 2,5 | M10            |
| 200  | 1,5 | M8+M10         | 560  | 2,5 | M10            |
| 225  | 1,5 | M8+M10         | 600  | 2,5 | M10            |
| 250  | 1,5 | M8+M10         | ...  | ... | ...            |



**SCP-B**  
Spiral Duct Clamp

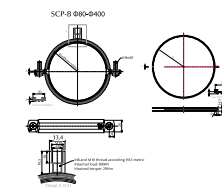

**SCP-C**  
Split Rings for Spiral Duct

- For suspension of circular ducting.
- For insulated duct it is recommended that the suspension ring is mounted inside the insulation.



**SCP-E**  
Pipe Clamp with Hex Nut

- Used for mounting of pipes to the walls(vertical/horizontal), ceilings and floors.
- EPDM lining for: noise reduction level up to 15 dB according to DIN 4109 vibration reduction partial compensation of thermal expansion
- Easy and safe assembly through Philips combi side screws.
- Side screws are protected against loss during assemble with the help of plastic washers.
- Electro galvanized for corrosion resistance (Plating thickness 8-10 micron).

| Size   | φD    | L   | H    | S*B    | M   | A   |
|--------|-------|-----|------|--------|-----|-----|
| 1/8"   | 8-11  | 50  | 16.5 | 1,0*20 | M6  | M8  |
| 1/4"   | 11-15 | 58  | 18   | 1,0*20 | M6  | M8  |
| 3/8"   | 16-20 | 61  | 19.5 | 1,0*20 | M6  | M8  |
| 1/2"   | 20-24 | 63  | 22   | 1,0*20 | M6  | M8  |
| 3/4"   | 25-28 | 69  | 24   | 1,0*20 | M6  | M8  |
| 1"     | 32-35 | 77  | 28   | 1,2*20 | M6  | M8  |
| 1 1/4" | 39-46 | 84  | 31.5 | 1,2*20 | M6  | M8  |
| ...    | ...   | ... | ...  | ...    | ... | ... |



**SCP-D**  
Suspension Clamp for Air Duct

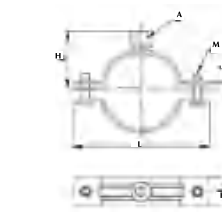



**SCP-H**  
Sprinkler Clamp

- Used for freely hanging of horizontal pipe lines.
- Used for sprinkler system installations.
- Used for fire extinguishing systems.
- Height adjustment through threaded rods.
- Electro galvanized for corrosion resistance (Plating thickness 8-10 micron)



**TRS**  
Terrace Roof Stand

- Support of circular duct, Variable height from 280 to 450mm screws M8
- 150×100mm or 300×300mm base plate.



**FHW**  
Fast Hanging Wire Kit



**RLC**  
Rapid Lock Pipe Clamp



**PB**  
Steel Perforated Band

- Made of galvanized perforated steel with assorted holes, which selected according to the type, allow fixing of threaded rods, threaded clamps, bolts, etc.
- The small holes can be used with rivets, screws or nails.

| Width×Thickness mm | Roll length m |
|--------------------|---------------|
| 17×0.6/ 0.8/1.0    | 10/25         |
| 20×0.6/ 0.8/1.0    | 10/25         |
| 25×0.6/ 0.8/1.0    | 10/25         |



**PB-D**  
Dispenser Perforated Band

- 10m per rolls perforated band with a plastic dispenser, which can be collected and handled easily.

| Material         | Width×Thickness mm | Roll length m | Hole Diameter φ mm |
|------------------|--------------------|---------------|--------------------|
| galvanized steel | 12×0.6             | 10            | 5                  |
| galvanized steel | 17×0.6             | 10            | 7                  |



**LH**  
L Holder



**ZH**  
Z Holder

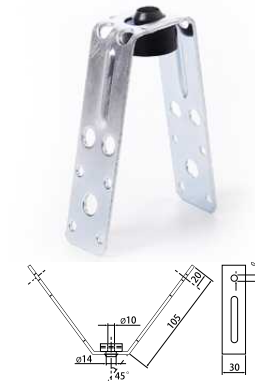

**VH**  
V Holder



**VHN**  
V Holder with Nut



**ZHF**  
Holder French Z Type



**AHF**  
Holder French A Type



**LHF**  
Holder French L Type



**SAB**  
Shock Absorber



**CCH**  
C Channel

- Surface finish: Electro zinc plated.
- Available as plain or slotted.

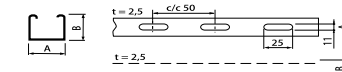

| Dim |    | Length (mm) | Thickness t(mm) |
|-----|----|-------------|-----------------|
| A   | B  |             |                 |
| 41  | 21 | 3000        | 1.6             |
| 41  | 21 | 6000        | 2.5             |
| 41  | 41 | 3000        | 1.6             |
| 41  | 41 | 6000        | 2.5             |



**NMN**  
Nut Mount

| d     | A   | B  | C  | G  | H  | E  | S |
|-------|-----|----|----|----|----|----|---|
| M8/10 | 80  | 30 | 16 | 18 | 9  | 52 | 3 |
| M8/10 | 120 | 40 | 17 | 18 | 11 | 80 | 4 |



**BCP**  
Beam Clamp

- Used for the mounting of parts of air conditioning and ventilation systems on beams of max 19mm thickness.
- In combination with threaded rods.
- Available in size: M6, M8, M10, M12.



**TRD**  
Threaded Rod

- The threaded rod is produced according to the standard DIN 976-1.
- Threaded Rod acts as a connector in hanging of air ducts systems.
- Galvanized plated against corrosion.
- Grade: 4.8



**SSC**  
Stiffening Steel Cross

- Designed for cross connection of big diameters stiffening pipes.
- Made of 3mm galvanized steel, which guarantees resistance to high temperatures necessary.



**CNUS**  
Channel Nut With Long Spring



Support Channel Fittings and Brackets

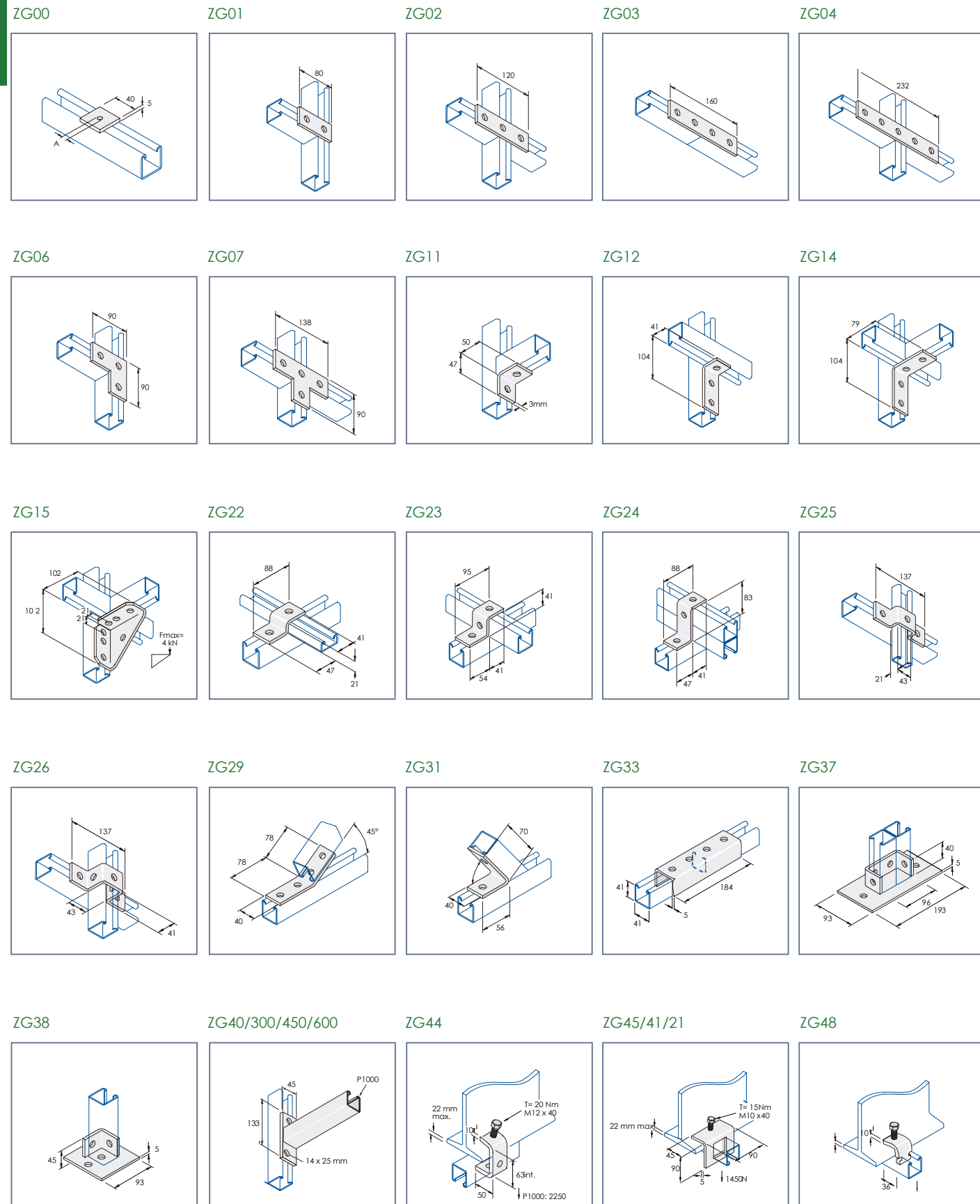

Ductwork Assembly



**FCN**  
Flexible Duct Connector

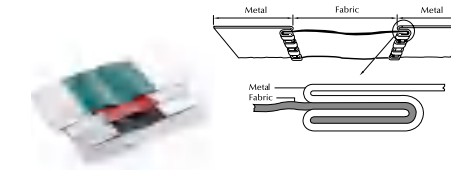

- Help to prevent transmission of vibration and noise between air treatment group and a ductwork.
- Different types of connections are available (metal or fibre) so that the user could choose the best solution for installation.
- Temperature range from -30 C to +250 C according to different fabric used.

| Metal+ Coated Fabric+Metal | Length  |
|----------------------------|---------|
| 35mmx60mmx35mm             | 25m/50m |
| 45mmx60mmx45mm             | 25m/50m |
| 45mmx70mmx45mm             | 25m/50m |
| 45mmx75mmx45mm             | 25m/50m |
| 70mmx100mmx70mm            | 25m/50m |



|                   | PVC                               | Silicone   | Canvas                          |
|-------------------|-----------------------------------|--|---------------------------------|
| Base Fabric       | Polyester                         | Fiber glass  | Cotton                          |
| Coating           | PVC (Both Sides)                  | Silicone (Both Sides)                                  | Chemical Coating                |
| Color             | Grey & Black                      | Grey   | Green                           |
| Temperature Range | -30 C / +80 C                     | -50 C / +280 C   | +80 C                           |
| Fire Resistance   | Fire Retardant                    | Fabric: non-combustible<br>Coating: fl ame proof       | Fire Retardant                  |
| Specifications    | Suitable for general applications | Suitable for high temperature applications (400 C /2h) | Versatile and cost effective    |
|                   | Economical choice                 | High resistance to weathering and chemicals            | Resistant to humidity and milds |

**GCP**  
Duct Flange Clamp



- For the intermediate clamping of slide on flange systems.
- Can be used in conjunction with all rectangular flange systems.
- M8x25mm bolt.
- Thickness-2.5 and 3mm
- Material-Formed Zinc-Coated Steel.

**VF**  
Vane Fastener



- This connector allows the user to install air fins with 0.4-1.13mm sheet metal in ventilation segmented fittings.
- Made of galvanized steel.
- Supplied with a rubber gasket which makes the connection air tight.

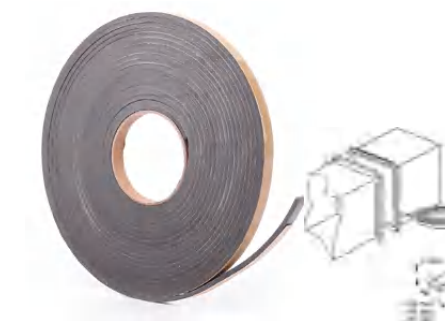

**EFTP**  
EVA Foam Tape (EVA Gasket Tape)



PaIDuct Components & Accessories

Duct Corners



Air Diffuser and Grille  
Flexible Air Duct, Plastic Air Duct  
Spiral Duct and Fitting, Damper, Access Door  
Ductwork Components and Accessories  
Adhesive Tape, Thermal Insulation Material, Sealant  
Ventilation Air Filters  
Ventilation Fans





**Fasteners**

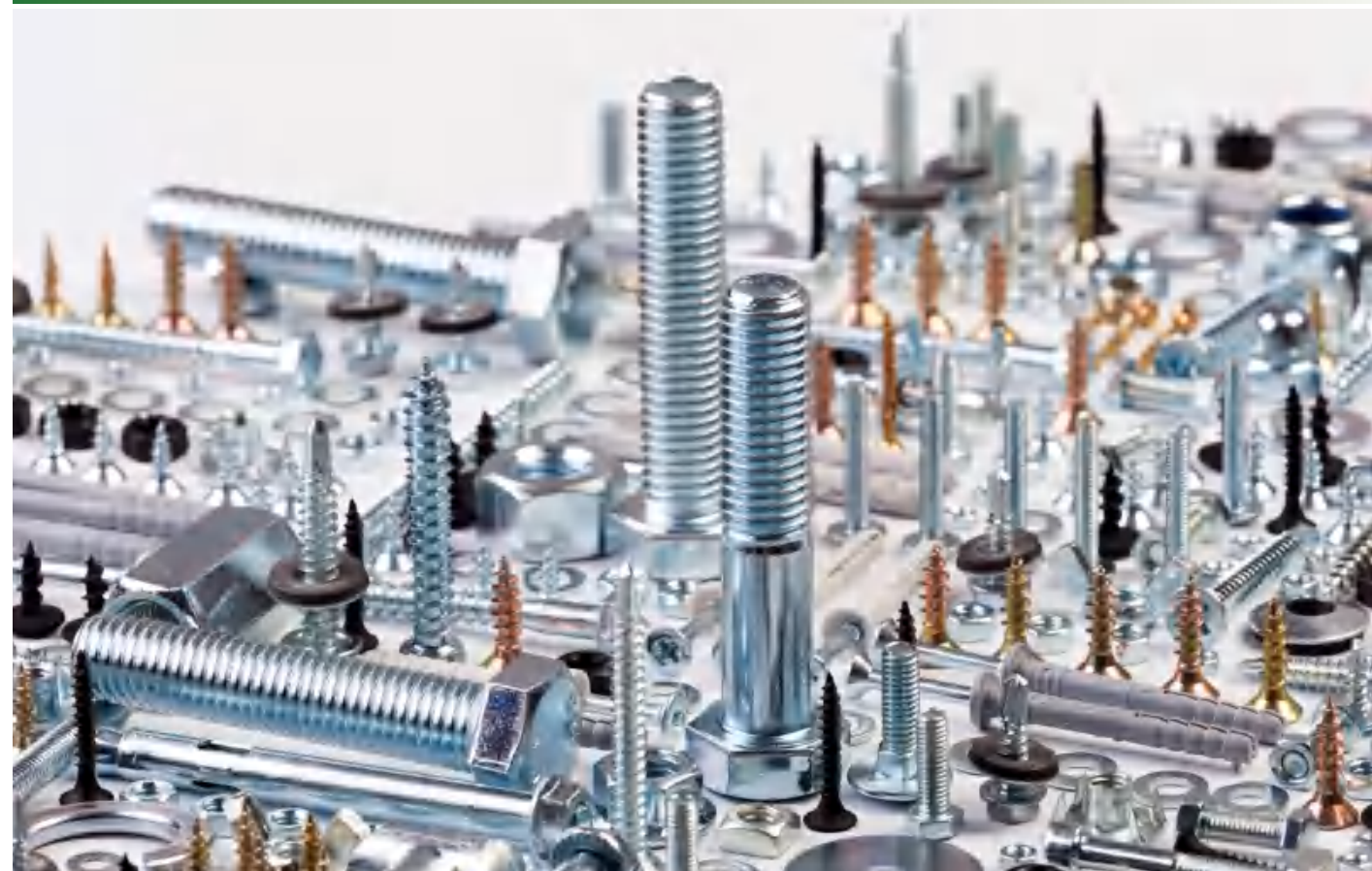

**HWS** Hex Head Wood Screw  
**HHB** Hex Head Bolt  
**HHBF** Hex Head Bolt with Flange  
**HN** Hex Nut  
**HNF** Hex Nut with Flange



**CNU** Hex Coupling Nut  
**CPW** Circular Plain Washer  
**DTS** Double Thread Screw  
**UBT** U Bolt  
**NYP** Nylon Plug



**SDIA** Steel Drop In Anchor  
**BDIA** Brass Drop In Anchor  
**WA** Wedge Anchor  
**BR** Pressure-tight blind rivet  
**BRO** Blind Rivet Open End



**SSH** Steel Screws with Hex Head  
**SDSR** Self-drilling Screws with Square Recess Head  
**SDSH** Self-drilling Screws with Hex Head  
**SDSC** Self-drilling Screws with Cross Head  
**SCA** Screw Cap

Adhesive Tape, Thermal Insulation Material, Sealant

Adhesive Tapes



Thermal Insulation Material



Sealant



Adhesive Tapes



**AF**  
Aluminium Foil Tape

- Aluminum foil tape is made of soft and high-strength pure aluminum foil, coated with high-performance pressure-sensitive adhesive, and compounded with single-sided coating polyethylene and silicone release paper.

| Foil Thickness | Adhesive System | Peel Strength | Initial Tack | Holding Power | Temperature Resistance |
|----------------|-----------------|---------------|--------------|---------------|------------------------|
| 18-50µm        | Acrylic/Rubber  | ≥18N/25mm     | ≤200mm       | ≥24h          | -20~+120 C             |



**AFSK**  
Aluminium Reinforced Tape

- The aluminium reinforced foil tape is made of reinforced aluminum foil, coated with high-performance pressure-sensitive adhesive, and compounded with single-sided polyethylene and silicone release paper.

| Foil Thickness | Adhesive System | Peel Strength | Initial Tack | Temperature Resistance |
|----------------|-----------------|---------------|--------------|------------------------|
| 7µm            | Acrylic/Rubber  | ≥20N/25mm     | ≤200mm       | -20~+120 C             |



**AFG**  
Aluminium Glass Cloth Tape

- The aluminium glass cloth tape is made of Glass fiber cloth, coated with high-performance pressure-sensitive adhesive, and compounded with single-sided polyethylene and silicone release paper.

| Foil Thickness | Adhesive System | Peel Strength | Initial Tack | Temperature Resistance |
|----------------|-----------------|---------------|--------------|------------------------|
| 7/18µm         | Acrylic/Rubber  | ≥20N/25mm     | ≤200mm       | -20~+120 C             |



**AFSW**  
Self Wound Aluminium Foil Tape

- Aluminum foil tape products are made of soft and high-strength pure aluminum foil/ PET composite aluminum foil, coated with high-performance pressure-sensitive adhesive.

| Foil Thickness | Adhesive System | Peel Strength | Initial Tack | Holding Power | Temperature Resistance |
|----------------|-----------------|---------------|--------------|---------------|------------------------|
| 30-75µm        | Acrylic/Rubber  | ≥15N/25mm     | ≤200mm       | ≥24h          | -20~+120 C             |



**PMTTP**  
PP Metalized Tape

- Single sided self adhesive tape with aluminum duct.
- Used to steam tighten AC or central heating systems.

| Total thickness | Glue  | Temperature range | Peel adhesion |
|-----------------|-------|-------------------|---------------|
| 0.05mm          | Acryl | -20 C - +80 C     | 25 N / 25mm   |



**PTP**  
PVC Duct Tape

- PVC tape with an adhesive coat on one side.
- Used on ductwork to provide an airtight seal, a secure and long lasting.

| Length   | Usage temperature | Total thickness | Adhesive type    | Color                 |
|----------|-------------------|-----------------|------------------|-----------------------|
| 10/20/50 | -10 C / +80 C     | 190µ            | synthetic rubber | black white grey etc. |



**URTP**  
Universal Repair Tape

- Single sided self adhesive tape is perfect for connecting insulations in AC and ventilation systems.

| Total thickness | Glue  | Temperature range | Peel Adhesion | Tensile Strength |
|-----------------|-------|-------------------|---------------|------------------|
| 0.22mm          | acryl | 0 C +80 C         | > 1.5 N/25mm  | 8 N/cm           |



**GTP**  
Glassfiber Tape

- The product is woven into mesh with fiberglass and coated with anti-alkaline resin.
- Very strong, self-adhesive, dimensionally stable and corrosion resistant.

| Width (mm) | Thickness (mm) | Tensile strength | Elongation at break |
|------------|----------------|------------------|---------------------|
| 10-150     | 0.8-3.0        | 570-870N/25mm    | 106%-107%           |

Air Diffuser and Grille

Flexible Air Duct, Plastic Air Duct

Spiral Duct and Fitting, Damper, Access Door

Ductwork Components and Accessories

Adhesive Tape, Thermal Insulation Material, Sealant

Ventilation Air Filters

Ventilation Fans





**EFTA**  
EVA Foam Tape

- Material: EVA Foam
- Size: 5mm×10mm×15m  
5mm×15mm×15m  
5mm×20mm×15m  
5mm×25mm×15m  
5mm×50mm×15m



**RFTP**  
Rubber Foam Tape

- Made of synthetic rubber, helps to avoid condensation.
- Standard size: 3mm×50mm×9.14m
- Packing: Individual carton and then every 30 rolls in a master carton.



**RFTP-R**  
Rubber Reinforced Foam Tape

- Specially made with reinforced polyester net to give extra strength to the insulation.
- Standard size: 3mm×50mm×9.14m
- Packing: Individual carton and then every 30 rolls in a master carton.



**PETP**  
XPE Foam Tape

- Made of Crosslinked PE Foam.
- Standard size: 3mm×50mm×9.14m
- Packing: Individual carton and then every 30 rolls in a master carton.

Thermal Insulation Material



**GWR**  
Glass Wool Insulation



**GWR-A**  
Glass Wool with Aluminum Foil

- Glass wool duct insulation of 25 mm thickness.
- Size: 1.2x20m
- For thermal and acoustic insulation of HVAC ductwork applications.
- Material: Glass wool with horizontally orientated glasswool fibers, glued on a reinforced aluminum foil of 20 μ thickness.
- Colour: Yellow mineral glasswool with reinforced aluminum foil.



**RIR**  
Rubber Insulation Sheet



**SRIR**  
Self-adhesive Rubber Insulation Sheet

- Available in several thicknesses and self-adhesive.
- Meet most of the needs in the fields of both civil and industrial plants for refrigeration, air conditioning, heating and plumbing, the insulation of tanks, pipe fittings, water ducts etc.
- The sheet is designed for the insulation on very large surfaces.
- Material: Synthetic rubber with closed cell structure.
- Standard Size:  
TK: 6mm; 10mm; 13mm; 19mm; 25mm  
Width: 1m; 1.2m Length: 10m; 20m



**SPEFR**  
Self-adhesive XPE Foam Sheet

- Available in several thicknesses 3mm-25mm and self-adhesive.
- XPE foam color: white, black, blue, grey, orange, pink, etc.



**PEFR-A**  
XPE Foam with Aluminum Foil

- Available in several thicknesses 3mm-25mm with Aluminum.
- XPE foam color: white, black, blue, grey, orange, pink, etc.
- Pure Aluminum/Metallic Aluminum thickness: 7 micron/12 micron



**SIP**  
Self Adhesive Insulation Pins

- 50mm Square Self-Adhesive Base
- Zinc plated steel pins with lengths: 19mm, 25mm, 32mm, 42mm, 51mm, 63mm, 75mm, 89mm, 105mm, 114mm

Sealant



**NASS**  
Acetic Silicone Sealant

- Single-component non-shrinkable silicone sealant.
- High elasticity, setting with air moisture, resistant to changing weather conditions and UV radiation.



**FPUF**  
Fire Retardant PU Foam

- Fire resistant PU foams used to close construction openings in compartmentation walls.
- To cover holes in compartmentation walls around fire dampers.



**NSS**  
Neutral Silicone Sealant

- Our silicone based sealant is a multi purpose, high modulus silicone sealant with fungicide.
- It is supplied in cartridge form (310ml) and is suitable for sealing and waterproofing in areas of high humidity.
- Excellent adhesion to glazed surfaces, or surface with plastics and paints.
- Resistant to temperatures from -50 °C to +150 °C
- Available in Translucent, White, Brown, Grey, Black.



**ZSP**  
Zinc Spray Paint

- Protect metal surfaces from corrosion Permanently.
- Repair of cut, heat sealed and welded elements, Spotting of damaged galvanized elements.
- Applying corrections after galvanization, heat sealing and welding.
- Excellent resistance to abrasion, excellent covering power.
- Highly efficient and economical.
- Resistant to high temperatures.
- Short drying time: the surface is resistant to touching after 2-3 minutes; Complete drying time 30 minutes.
- Silver colour.



**RFLR**  
Roof Flashing Rubber EPD



**RFLS**  
Roof Flashing Silicone

- Our roof flashing flexible is designed to meets virtually all roofing needs.
- The easy on-site customization allows for easy installation in usually 5 minutes.
- The flexible soft aluminum base is designed to form a seal on most panel configurations and roof pitches regardless of pipe location.
- Color: Black, Silver, Red, Grey, Brown, Terra-cotta.
- The temperature resistance for EPDM Roof flashing is from -50 °C to 160 °C ; silicone roof flashing is from -60 °C to 180 °C .
- Wide range of roof flashing: (0-18"=0-450mm) dia pipe.

Adhesive Tape, Thermal Insulation Material, Sealant

Air Diffuser and Grille

Flexible Air Duct, Plastic Air Duct

Spiral Duct and Fitting, Damper, Access Door

Ductwork Components and Accessories

Adhesive Tape, Thermal Insulation Material, Sealant

Ventilation Air Filters

Ventilation Fans



Ventilation Air Filters

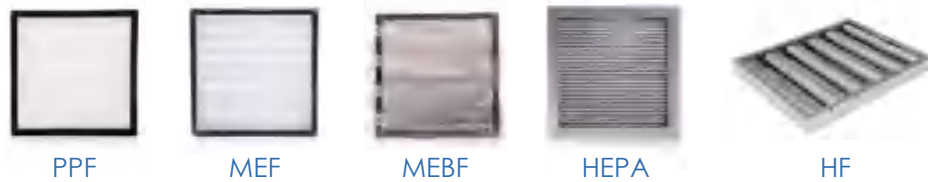

Ventilation Air Filters



PPF

Pleated Pre-Filter

- Application: Pre-filtration in central air conditioning and cabinet ventilation system.
- Features: Each pocket can be fully inflated; Maintain a proper spacing under the design of V-shaped. The clean air comes out from the front of the exit to the back. Bag filter and metal frame are glued to ensure seal ability.

| The Main Parameters   |  |
|-----------------------|--|
| Frame Material        | Paper/Aluminium/Galvanized steel/Stainless steel |
| Filter Media          | Synthetic/Fiberglass                             |
| Support               | Aluminium/Galvanized steel mesh                  |
| Working Condition     | Temperature: ≤90 C /Humidity:≤95% RH             |
| Filtration Efficiency | G3(EN779): 80%, G4(EN779): 90-95%                |



MEF

Medium Efficiency Filter

- Application: Indoor air quality equipments and automotive air conditioning system.
- Features: Ultra low pressure, Compact structure, Completely burned, Long service life.

| The Main Parameters |                    |
|---------------------|--------------------|
| Frame Material      | Carboard/Polyester |
| Filter Media        | Low Pressure PP    |
| Dimension           | Customized         |
| Efficiency          | F5~F9/MERV9~MERV14 |



MEBF

Medium Efficiency Bag Filter

- Application: Industrial purification of central HVAC system, pharmaceuticals, hospitals, electronics, food plant, pre-filtration ahead of HEPA filter, etc.
- Features: Each pocket can be fully inflated and also maintain a proper spacing under the design of V-shaped. The clean air comes out from the front of the exit to the back. Media and metal frame are glued to ensure sealability.

| The Main Parameters   |  |
|-----------------------|--|
| Frame Material        | Aluminium/Galvanized steel/ABS                               |
| Filter Media          | Synthetic Fiber  |
| Sealing Strip         | Polyurethane   |
| Working Condition     | Temperature: ≤70 C /Humidity:≤80% RH                         |
| Filtration Efficiency | F5-F6(EN 779): 50%-75%@0.3µm<br>F7-F9(EN 779): 80%-95%@0.3µm |



HEPA

High Efficiency(HEPA) Filter

- Application: Terminal filtration in environments and Industries which requires extremely high levels of Cleanliness, such as electronics and semiconductor manufacturing, precision machinery, pharmaceuticals, hospitals, food processing, etc.
- Features: Ultra-fine glass fiber paper ensure the excellent filtration efficiency throughout its operation life.
- Filters have high strength structure, low resistance and long working life.

| The Main Parameters   |  |
|-----------------------|--|
| Frame Material        | Aluminium/Galvanized steel/Stainless steel                 |
| Filter Media          | Ultra-fine glass fiber paper                               |
| Sealing Strip         | Polyurethane   |
| Support               | Welded steel wire  |
| Separator             | Aluminium foil/ Paper foil                                 |
| Working Condition     | Temperature: ≤90 C /Humidity:≤100% RH                      |
| Filtration Efficiency | H13(EN 1822): ≥99.97%@0.3µm<br>H14(EN 1822): ≥99.99%@0.3µm |



HF

Hood Filter

- Made of stainless steel/. Water, rust and deformation proof. Easy to clean and environmentally friendly with low maintenance cost.
- A handle is equipped on each side of the filter for easy installation and replacement of the grease filter.
- Grease holes are evenly distributed on both sides. The grease does not get stuck easily, and the holes are not easily plugged.

| The Main Parameters |   |
|---------------------|---|
| Product Type        | Baffle hood filter  |
| Frame Material      | Stainless steel/Aluminum/Galvanized steel                       |
| Color               | Silver  |
| Features            | Fireproof and heat-resistant<br>Easy to clean<br>Smooth surface |
| Packing             | Paper carton  |

| Model | Size         |
|-------|--------------|
| HF-1  | 492*492*40mm |
| HF-2  | 492*492*50mm |
| HF-3  | 495*495*40mm |
| HF-4  | 495*495*50mm |
| HF-5  | 500*500*40mm |
| HF-6  | 500*500*50mm |



Ventilation Fans



Inline Duct Fans



**FZY-YS**  
Circular Inline Duct Fan (Plastic Housing)

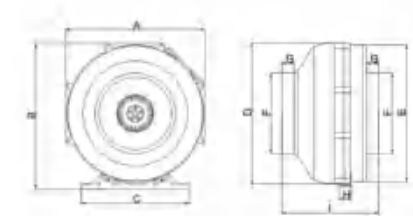

FZY Installation dimension sheet

| Model      | Size |     |     |      |      |      |    |    |     | Weight |
|------------|------|-----|-----|------|------|------|----|----|-----|--------|
|            | A    | B   | C   | D    | E    | F    | G  | H  | I   |        |
| FZY-100-YS | 147  | 257 | 270 | φ250 | φ240 | φ100 | 23 | 30 | 220 | 3.3    |
| FZY-125-YS | 147  | 257 | 270 | φ250 | φ240 | φ125 | 26 | 30 | 220 | 3.3    |
| FZY-150-YS | 285  | 298 | 270 | φ290 | φ280 | φ150 | 24 | 30 | 230 | 4.1    |
| FZY-160-YS | 285  | 298 | 270 | φ290 | φ280 | φ160 | 27 | 30 | 230 | 4.1    |
| FZY-200-YS | 345  | 361 | 270 | φ350 | φ340 | φ200 | 33 | 30 | 240 | 5      |
| FZY-250-YS | 345  | 361 | 270 | φ350 | φ340 | φ250 | 30 | 30 | 240 | 5      |
| FZY-315-YS | 432  | 411 | 270 | φ420 | φ410 | φ315 | 30 | 30 | 270 | 6.8    |

The main parameters

| Model (No) | Voltage (V) | Power (W) | Speed (r/min) | Air volume (m³/h) | Full-voltage (pa) | Noise dB (A) |
|------------|-------------|-----------|---------------|-------------------|-------------------|--------------|
| 100        | 220         | 75        | 2650          | 250               | 350               | 30           |
| 125        | 220         | 85        | 2650          | 275               | 390               | 32           |
| 150        | 220         | 140       | 2650          | 370               | 400               | 41           |
| 160        | 220         | 145       | 2650          | 590               | 420               | 45           |
| 200        | 220         | 180       | 2650          | 850               | 550               | 48           |
| 250        | 220         | 190       | 2650          | 1000              | 570               | 51           |
| 315        | 220         | 280       | 2650          | 1500              | 830               | 53           |



**FZY-YT**  
Circular Inline Duct Fan (Steel Housing)

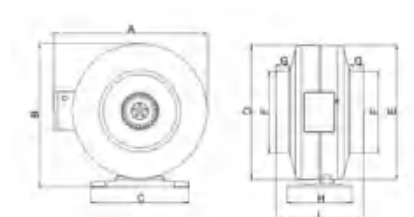

FZY Installation dimension sheet

| Model      | Size |     |     |      |      |      |    |     |     | Weight |
|------------|------|-----|-----|------|------|------|----|-----|-----|--------|
|            | A    | B   | C   | D    | E    | F    | G  | H   | I   |        |
| FZY-100-YT | 285  | 260 | 240 | φ240 | φ238 | φ100 | 23 | 160 | 195 | 4      |
| FZY-125-YT | 285  | 260 | 240 | φ240 | φ238 | φ125 | 26 | 160 | 195 | 4      |
| FZY-150-YT | 377  | 352 | 240 | φ330 | φ328 | φ150 | 24 | 160 | 220 | 5.6    |
| FZY-160-YT | 377  | 352 | 240 | φ330 | φ328 | φ160 | 27 | 160 | 220 | 5.6    |
| FZY-200-YT | 377  | 352 | 240 | φ330 | φ328 | φ200 | 33 | 160 | 215 | 6.3    |
| FZY-250-YT | 377  | 352 | 240 | φ330 | φ328 | φ250 | 30 | 160 | 210 | 6.4    |
| FZY-315-YT | 443  | 418 | 240 | φ395 | φ395 | φ315 | 30 | 160 | 245 | 6.8    |

The main parameters

| Model (No) | Voltage (V) | Power (W) | Speed (r/min) | Air volume (m³/h) | Full-voltage (pa) | Noise dB (A) |
|------------|-------------|-----------|---------------|-------------------|-------------------|--------------|
| 100        | 220         | 75        | 2650          | 250               | 350               | 30           |
| 125        | 220         | 85        | 2650          | 275               | 390               | 32           |
| 150        | 220         | 140       | 2650          | 370               | 400               | 41           |
| 160        | 220         | 145       | 2650          | 590               | 420               | 45           |
| 200        | 220         | 180       | 2650          | 850               | 550               | 48           |
| 250        | 220         | 190       | 2650          | 1000              | 570               | 51           |
| 315        | 220         | 280       | 2650          | 1500              | 830               | 53           |

Ventilation Fans

Air Diffuser and Grille

Flexible Air Duct, Plastic Air Duct

Spiral Duct and Fitting, Damper, Access Door

Ductwork Components and Accessories

Adhesive Tape, Thermal Insulation Material, Sealant

Ventilation Air Filters

Ventilation Fans



**YWF(K)**  
Single Inlet Centrifugal Fans (AC)

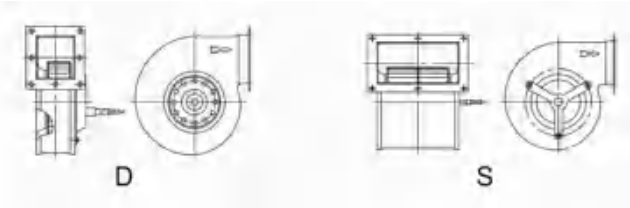

| Model            | Voltage (V) | Frequency (Hz) | Input power (W) | Current (A) | Speed (r/min) | Capacitor (uF) | Max Environmental temperature (C) | Weight (Kg) |
|------------------|-------------|----------------|-----------------|-------------|---------------|----------------|-----------------------------------|-------------|
| YWF(K)2E120-GQ-R | 230         | 50/60          | 62/82           | 0.28/0.37   | 2500/2630     | 2              | 60/50                             | 2.0         |
| YWF(K)2E133-GQ-R | 230         | 50/60          | 90/103          | 0.40/0.48   | 2000/1830     | 3              | 65/50                             | 2.2         |
| YWF(K)2E140-GQ-R | 230         | 50/60          | 188/210         | 0.85/0.97   | 2100/2300     | 6              | 70/45                             | 3.5         |
| YWF(K)2E150-GQ-R | 230         | 50/60          | 180/210         | 0.81/0.97   | 2200/2300     | 6              | 70/45                             | 3.4         |
| YWF(K)2E160-GQ-R | 230         | 50             | 280             | 1.25        | 2150          | 8              | 60                                | 3.9         |
| YWF(K)4E160-GQ-R | 230         | 50/60          | 67/85           | 0.29/0.37   | 1300/1400     | 2              | 60                                | 3.9         |



**HF**  
Mixed Flow Inline Duct Fan

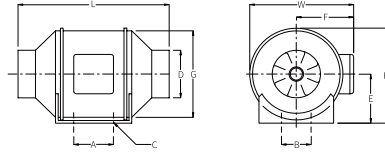

| Model   | A   | B   | C       | φD  | E   | F   | φG  | L   | W   | H   |
|---------|-----|-----|---------|-----|-----|-----|-----|-----|-----|-----|
| HF-100P | 80  | 60  | 4-φ4.5  | 97  | 99  | 116 | 163 | 302 | 204 | 195 |
| HF-125P | 80  | 60  | 4-φ4.5  | 123 | 99  | 116 | 163 | 257 | 204 | 195 |
| HF-150P | 80  | 60  | 4-φ5.0  | 147 | 109 | 127 | 187 | 313 | 227 | 208 |
| HF-200P | 100 | 94  | 4-φ5.5  | 197 | 125 | 137 | 205 | 302 | 249 | 237 |
| HF-250P | 150 | 150 | 4-φ8*11 | 247 | 150 | 174 | 261 | 383 | 310 | 286 |
| HF-315P | 181 | 178 | 4-φ8*11 | 312 | 187 | 216 | 325 | 446 | 386 | 357 |



**CZR**  
Centrifugal Blower

| Type       | Power (w) | Calibre of outlet (mm) | Current (A) | Pressure (Pa) | Flow (m3/min) | Voltage (V) | Frequency (HZ) | Rotational (RPM) |
|------------|-----------|------------------------|-------------|---------------|---------------|-------------|----------------|------------------|
| CZR 2"     | 150       | 50                     | 1.0         | 200           | 4.5           | 110-220     | 50-60          | 3000-3600        |
| CZR 2 2/1" | 250       | 63                     | 1.6         | 230           | 6.5           | 110-220     | 50-60          | 3000-3600        |
| CZR 3"     | 350       | 75                     | 2.0         | 270           | 9             | 110-220     | 50-60          | 3000-3600        |
| CZR 4"     | 550       | 100                    | 2.15        | 310           | 11            | 110-220     | 50-60          | 3000-3600        |
| CZR 5"     | 750       | 125                    | 3.5         | 350           | 13            | 110-220     | 50-60          | 3000-3600        |



**YNP**  
Push-Pull Exhaust Fan

**Bathroom Fan**



**Dongguan SHAMANA Trade Co., Ltd.**

HQ: Rm.101, 113 YongHuaXinCun, 43 YuXing Road, Shilong, Dongguan 523320, Guangdong

Branch Office: No.81 XingHu West Rd, HuShan New Business Village, ShiWan, Huizhou, Guangdong China

Phone: +86 400 8007103

Email: office@shamana-china.com

Web: www.shamana-china.com